

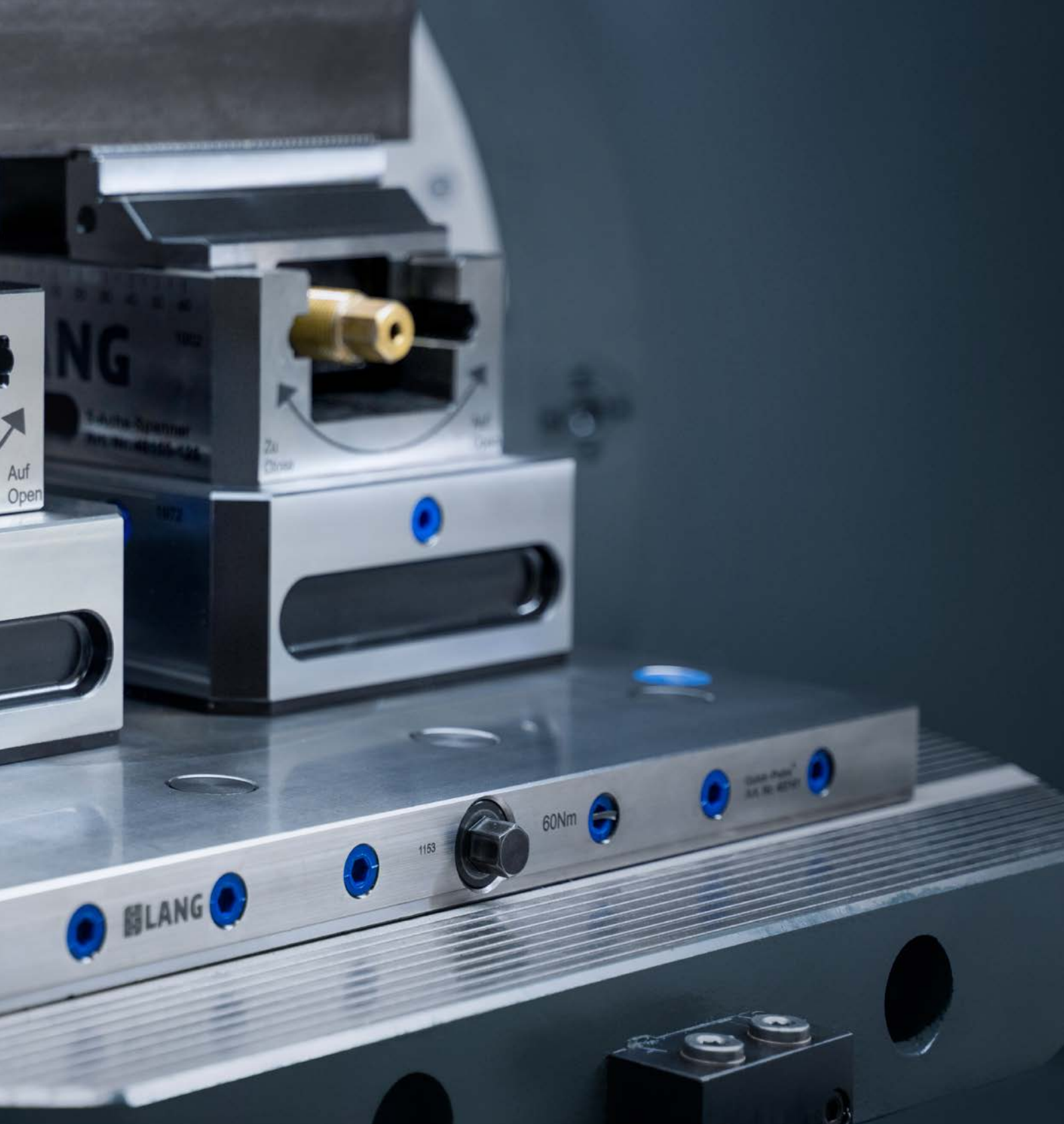

ZERO-POINT CLAMPING



- 20** Quick·Point® **Single Plates**
- 32** Quick·Point® **Multi Plates**
- 38** Quick·Point® **Adaptor Plates**
- 40** Quick·Point® **Risers**
- 44** Quick·Point® **Clamping Towers for Vertical Machining Centres**

- 48** Quick·Tower **Clamping Tower for Horizontal Machining Centres**
- 54** Quick·Point® **Accessories**
- 62** **Alignment and Mounting Options**
- 64** Quick·Point® **Service**

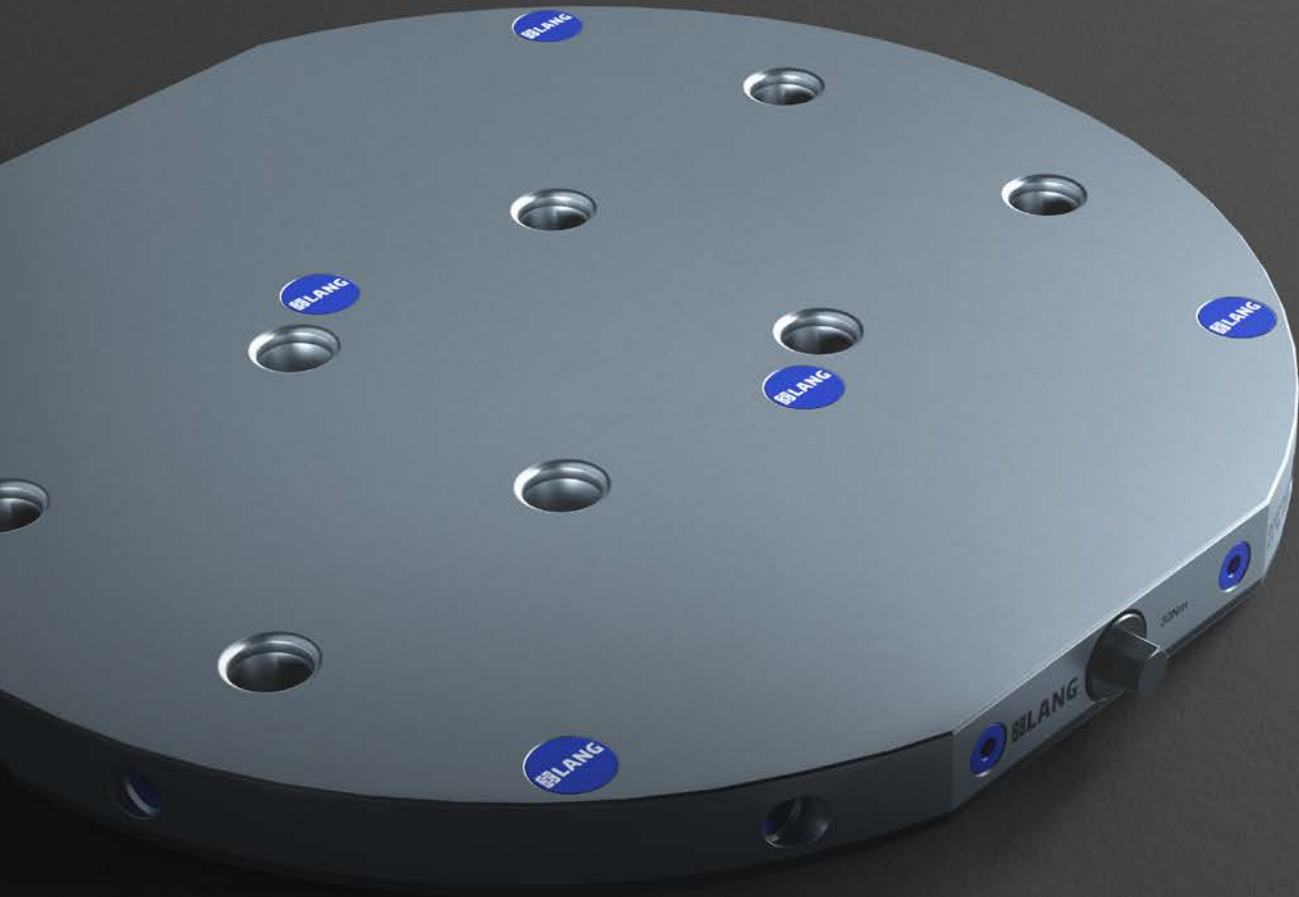

**simple.
quick.
clamping.**

Flexible, precise and extremely durable.

The Quick•Point® Zero-Point Clamping System combines:

SET-UP TIME SAVINGS

MODULARITY

SIMPLE, MECHANICAL OPERATION

As an interface between the machine table and clamping device, Quick•Point® is characterised by an enormous range of variations and high repeatability. Round, rectangular or square in shape, for single or multiple clamping, two different stud sizes and spacings (52 mm and 96 mm), Quick•Point® provides a solution for every application. It can be used universally in vertical and horizontal machining centres, on 3- and 5-axis tables and 4th axis rotary or trunnion systems. Due to its modularity the system can be expanded precisely at any time.

Benefits of the Quick•Point® Zero-Point Clamping System



Minimum setup
time required



Direct clamping
of workpieces



Wide range of
customisation options



Highly precise
positioning



Maintenance-free
and durable components



Automated, pneumatic
actuation possible

Quick•Point® Technology



- 1 With only 27 mm one of the lowest zero-point systems on the market
- 2 Highly precise with < 0.005 mm repeat accuracy
- 3 Cover discs for mounting bores
- 4 Robust mechanical clamping with one actuation screw or Quick-Lock fastener
- 5 Rigid, compact base plate made of case-hardened and ground steel

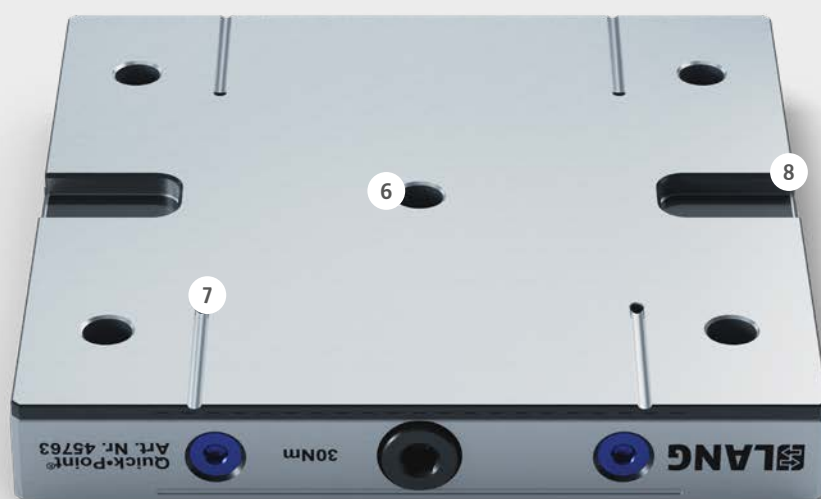

- 6 Ø12F5 fitting for concentric alignment, centring studs are also available (page 61)
- 7 Coolant drainage
- 8 20H7 keyways for axial alignment

Functional principle of Quick-Point® Zero-Point Plates

By design Quick-Point® is a purely mechanical zero-point system. A patented rod system inside the plate guarantees a repeatability of less than 0.005 mm. Quick-Point® plates are actuated by one screw or the Quick-Lock device to ensure simple and easy operation. With an actuation torque of 30 Nm (60 Nm for 4-fold grid plates) holding forces of up to 6.000 kg are realised. Due to a very small number of wear-free parts the system is reliable and virtually maintenance free.



Modular, flexible and always a good fit.

With nearly 50 different types of zero-point plates and diverse customisation possibilities Quick-Point® provides a suitable solution for every type of machine table. On large machine tables a continuous grid can be realised using (multi) grid plates in order to make best use of the available space. Quick-Point® unfolds its enormous modularity through complementary items, such as risers, tombstones and, in particular, adaptor plates with which the zero-point grid size can be reduced from 96 mm to 52 in order to use all sizes of LANG vices flexibly.

Recommendation:

If the size of the machine table allows it, we recommend, the larger Quick-Point® 96 zero point clamping system as the basis on the machine table. This ensures the greatest possible flexibility with regard to future system expansions. In this way, you remain flex-

ible and can use both larger vices or clamping systems such as Makro-Grip® Ultra, as well as smaller vices by adapting them to the Quick-Point® 52 zero-point clamping system.

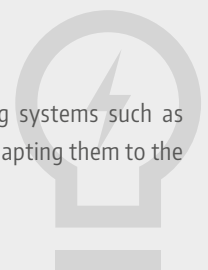



Direct clamping of workpieces and fixtures

Quick-Point® clamping studs connect the zero-point system and LANG workholding devices. They can be also mounted directly to a workpiece in order to clamp it directly without a workholding device. Even the mounting to customers' own fixtures or conventional vices is possible to benefit from all the advantages of the Quick-Point® zero-point clamping system. The connection between clamping studs and zero-point plate is extremely robust, very precise and can undoubtedly resist even the strongest machining forces.

Image: Poseidon Propulsion B.V.

High degree of customisation possibilities

All of our Quick-Point® plates with prefabricated mounting bores are also available without such, in order to be individually adapted to any kind of machine table. If the zero-point plate protrudes the machine table, cutting off the plate's corners provides a nice and clean customisation.



Image: Donner GmbH The Qualifactory



A great fit for rotary tables

The low overall height, the wide range of customisation options and the mechanical functional principle make the Quick-Point® zero-point clamping system a great choice for rotary tables, e.g. from Kitagawa, Lehmann, Nikken or Haas, just to name a few. Rotary tables and trunnions can be retrofitted easily with Quick-Point® plates which provide added value in terms of flexibility and set-up times.

Automated manufacturing

The Quick-Point® zero-point clamping system is used not only in manual but also in automated, lights-out manufacturing. The zero-point clamping system can be actuated either by the machine tool (pneumatically) or the robot gripper (mechanically or pneumatically). A media interface within the machine is not required.



Quick-Point® Single Plates

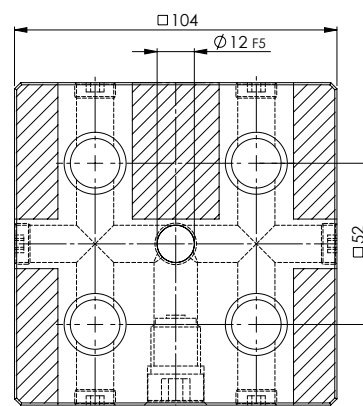

QUICK-POINT® 52, GRID PLATE 104 × 104 × 27 MM, WITHOUT MOUNTING BORES



ITEM NO.	DIMENSIONS	WEIGHT
45600	104 × 104 × 27 mm	2.0 kg
45004	Set mounting bores according to customer's request	
45002	Set keyways according to customer's request	

Suitable Quick-Lock: Item No. 44552 (page 58)

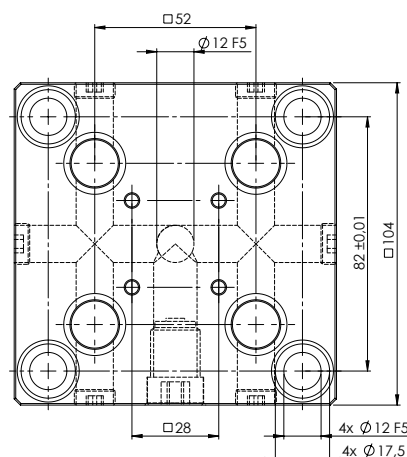

QUICK-POINT® 52, GRID PLATE 104 × 104 × 27 MM, WITH MOUNTING BORES FOR QUICK-TOWER

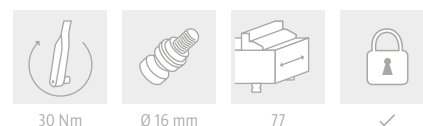

ITEM NO.	DIMENSIONS	MOUNTING BORES	WEIGHT
75600	104 × 104 × 27 mm	82 × 82 mm	1.8 kg

This Grid Plate can also be found on page 46 & 52.

Suitable Quick-Lock: Item No. 44552 (page 58)

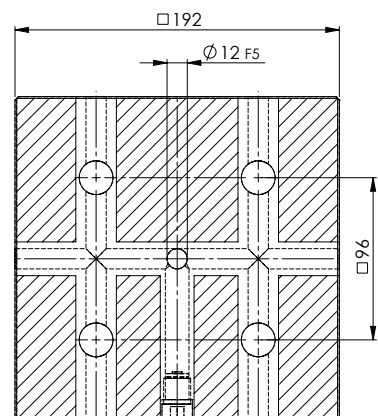

QUICK-POINT® 96, GRID PLATE
192 × 192 × 27 MM, WITHOUT MOUNTING BORES

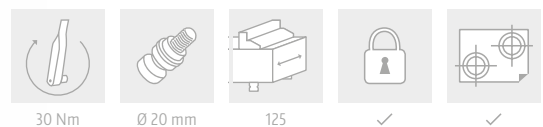

ITEM NO.	DIMENSIONS	WEIGHT
45710	192 × 192 × 27 mm	7.2 kg
45004	Set mounting bores according to customer's request	
45002	Set keyways according to customer's request	

Suitable Quick-Lock: Item No. 44596 (page 58)

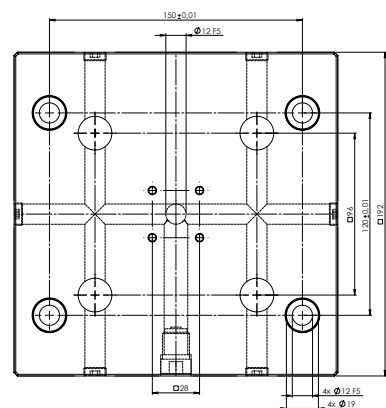

QUICK-POINT® 96, GRID PLATE
192 × 192 × 27 MM, WITH MOUNTING BORES FOR QUICK-TOWER

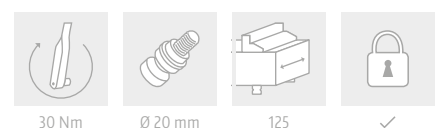

ITEM NO.	DIMENSIONS	MOUNTING BORES	WEIGHT
75710	192 × 192 × 27 mm	150 × 120 mm	7.0 kg

This Grid Plate can also be found on page 53.
 Suitable Quick-Lock: Item No. 44596 (page 58)

Quick-Point® Single Plates

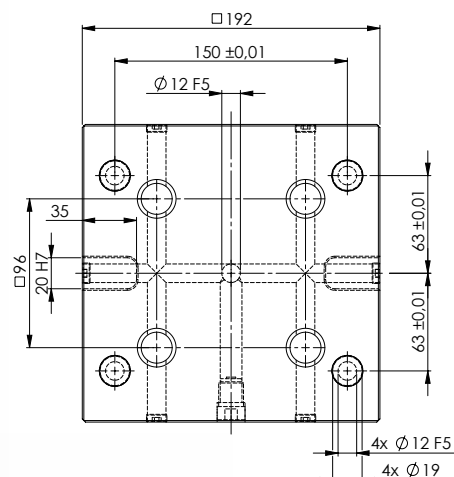

QUICK-POINT® 96, GRID PLATE

192 × 192 × 27 MM, WITH MOUNTING BORES FOR 63 MM T-SLOT DISTANCE

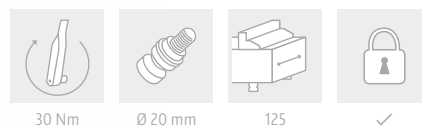

ITEM NO.	DIMENSIONS	MOUNTING BORES	WEIGHT
45763	192 × 192 × 27 mm	for 63 mm t-slot distance	7.0 kg

Suitable Quick-Lock: Item No. 44596 (page 58)

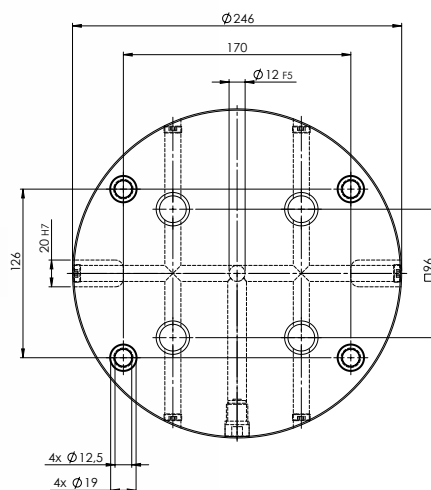

QUICK-POINT® 96, ROUND PLATE

Ø 246 × 27 MM, WITH MOUNTING BORES FOR 63 MM T-SLOT DISTANCE

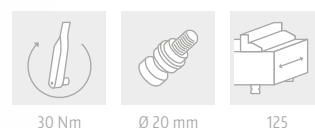

ITEM NO.	DIMENSIONS	MOUNTING BORES	WEIGHT
45863	Ø 246 × 27 mm	for 63 mm t-slot distance	9.3 kg

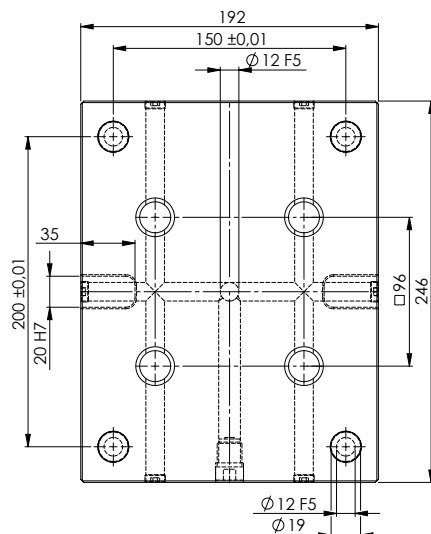

QUICK-POINT® 96, EXTENDED GRID PLATE
246 × 192 × 27 MM, WITH MOUNTING BORES FOR 100 MM T-SLOT DISTANCE

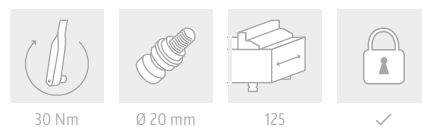

ITEM NO.	DIMENSIONS	MOUNTING BORES	WEIGHT
45715	246 × 192 × 27 mm	for 100 mm t-slot distance	9.2 kg

Suitable Quick-Lock: Item No. 44596 (page 58)

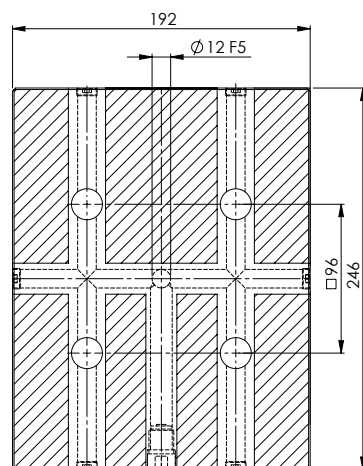

QUICK-POINT® 96, EXTENDED GRID PLATE
246 × 192 × 27 MM, WITHOUT MOUNTING BORES

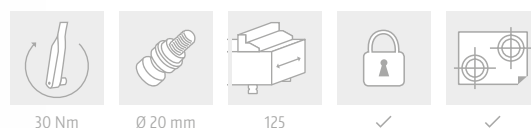

ITEM NO.	DIMENSIONS	WEIGHT
45716	246 × 192 × 27 mm	9.4 kg
45004	Set mounting bores according to customer's request	
45002	Set keyways according to customer's request	

Suitable Quick-Lock: Item No. 44596 (page 58)

Quick-Point® Single Plates

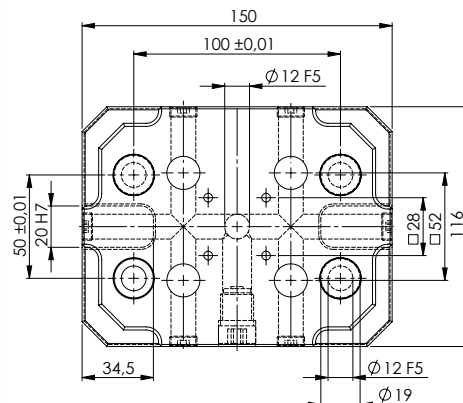

QUICK-POINT® 52, RECTANGULAR PLATE 150 × 116 × 27 MM, WITH CLAMPING EDGE & MOUNTING BORES

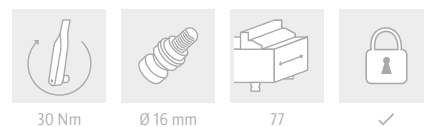

ITEM NO.	DIMENSIONS	MOUNTING BORES	WEIGHT
45150	150 × 116 × 27 mm	100 × 50 mm	2.9 kg

Suitable Quick-Lock: Item No. 44552 (page 58)

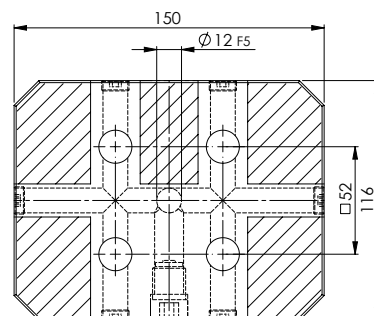

QUICK-POINT® 52, RECTANGULAR PLATE 150 × 116 × 27 MM, WITHOUT CLAMPING EDGE & MOUNTING BORES



ITEM NO.	DIMENSIONS	WEIGHT
45151	150 × 116 × 27 mm	3.4 kg
45004	Set mounting bores according to customer's request	
45002	Set keyways according to customer's request	

Suitable Quick-Lock: Item No. 44552 (page 58)

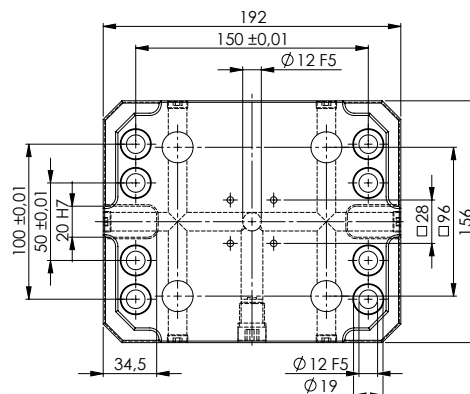

QUICK-POINT® 96, RECTANGULAR PLATE 192 × 156 × 27 MM, WITH CLAMPING EDGE & MOUNTING BORES

ITEM NO.	DIMENSIONS	MOUNTING BORES	WEIGHT
45400	192 × 156 × 27 mm	150 × 100 / 50 mm	5.5 kg

Suitable Quick-Lock: Item No. 44596 (page 58)

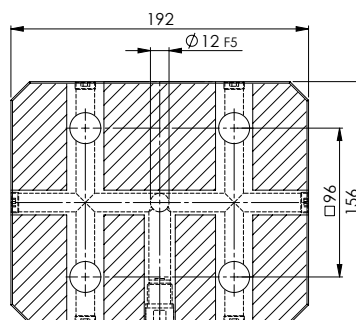
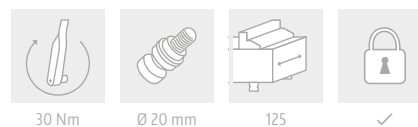

QUICK-POINT® 96, RECTANGULAR PLATE 192 × 156 × 27 MM, WITHOUT CLAMPING EDGE & MOUNTING BORES

ITEM NO.	DIMENSIONS	WEIGHT
45401	192 × 156 × 27 mm	6.0 kg
45004	Set mounting bores according to customer's request	
45002	Set keyways according to customer's request	

Suitable Quick-Lock: Item No. 44596 (page 58)

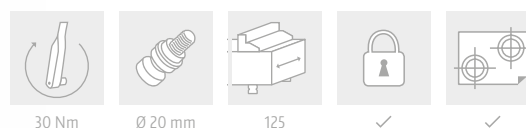

Quick-Point® Single Plates

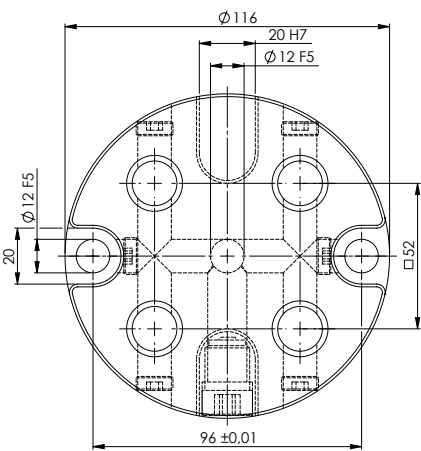

QUICK-POINT® 52, ROUND PLATE
Ø 116 × 27 MM



30 Nm



Ø 16 mm



77

ITEM NO.	DIMENSIONS	MOUNTING BORES	WEIGHT
45750	Ø 116 × 27 mm	96 mm distance	1.9 kg

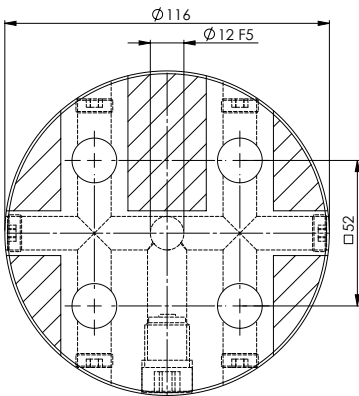

QUICK-POINT® 52, ROUND PLATE
Ø 116 × 27 MM, WITHOUT MOUNTING BORES



30 Nm



Ø 16 mm



77



✓

ITEM NO.	DIMENSIONS	WEIGHT
45751	Ø 116 × 27 mm	2.1 kg
45004	Set mounting bores according to customer's request	
45002	Set keyways according to customer's request	

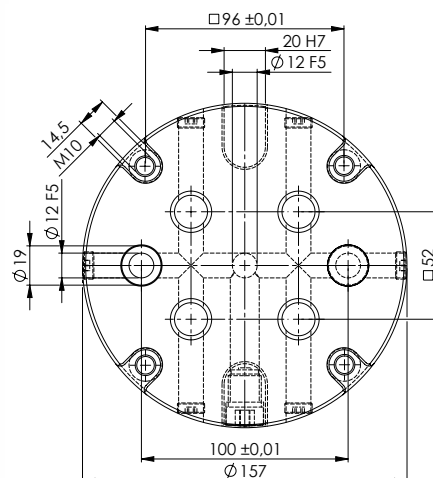

QUICK-POINT® 52, ROUND PLATE Ø 157 × 27 MM

ITEM NO.	DIMENSIONS	MOUNTING BORES	WEIGHT
45900	Ø 157 × 27 mm	100 mm distance	3.5 kg

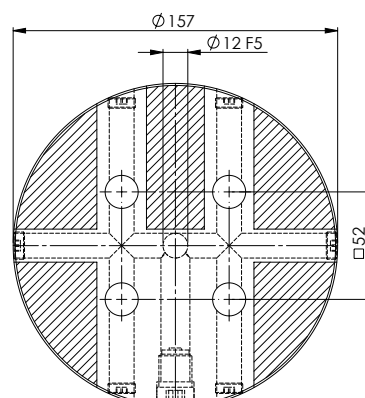
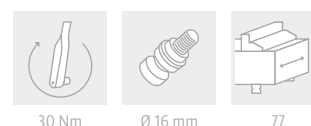

QUICK-POINT® 52, ROUND PLATE Ø 157 × 27 MM, WITHOUT MOUNTING BORES

ITEM NO.	DIMENSIONS	WEIGHT
45901	Ø 157 × 27 mm	3.8 kg
45004	Set mounting bores according to customer's request	
45002	Set keyways according to customer's request	

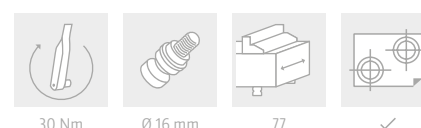

Quick-Point® Single Plates

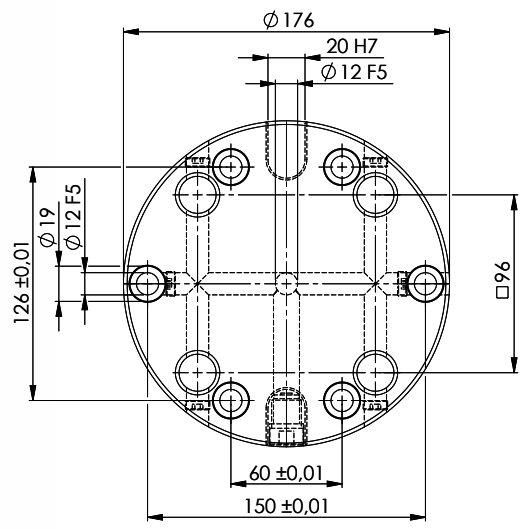

QUICK-POINT® 96, ROUND PLATE
Ø 176 × 27 MM

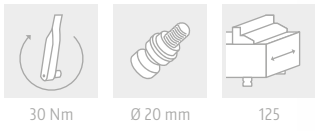

ITEM NO.	DIMENSIONS	MOUNTING BORES	WEIGHT
45800	Ø 176 × 27 mm	for 63 mm t-slot distance & 150 mm distance	4.7 kg

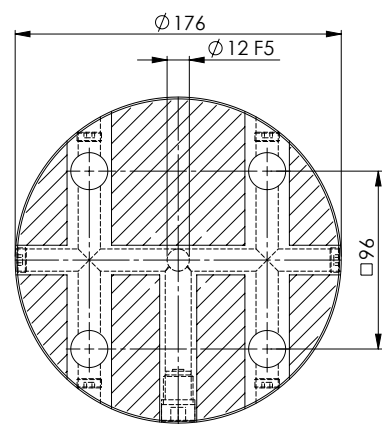

QUICK-POINT® 96, ROUND PLATE
Ø 176 × 27 MM, WITHOUT MOUNTING BORES

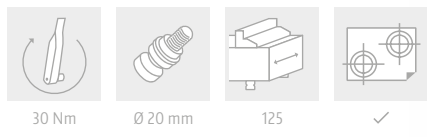

ITEM NO.	DIMENSIONS	WEIGHT
45801	Ø 176 × 27 mm	4.8 kg
45004	Set mounting bores according to customer's request	
45002	Set keyways according to customer's request	

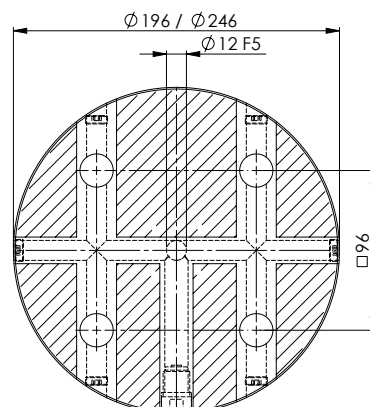

QUICK-POINT® 96, ROUND PLATES
Ø 196 / 246 × 27 MM, WITHOUT MOUNTING BORES

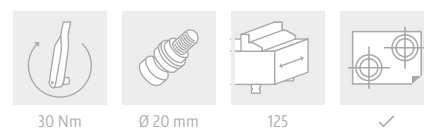

ITEM NO.	DIMENSIONS	WEIGHT
45820	Ø 196 × 27 mm	6.0 kg
45840	Ø 246 × 27 mm	9.5 kg
45004	Set mounting bores according to customer's request	
45002	Set keyways according to customer's request	

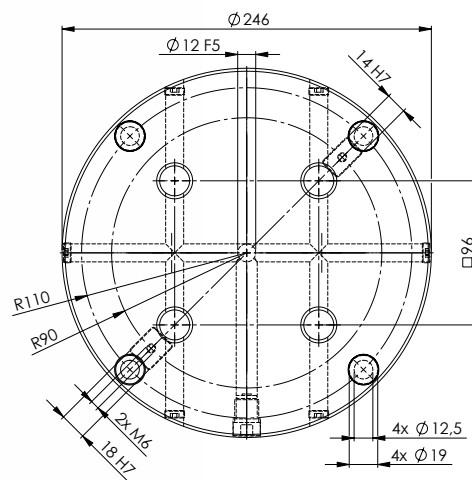

QUICK-POINT® 96, ROUND PLATE
Ø 246 × 27 MM, WITH MOUNTING BORES FOR TABLES WITH 90° GROOVES

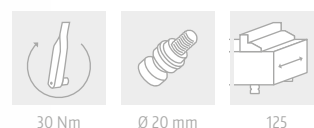

ITEM NO.	DIMENSIONS	MOUNTING BORES	WEIGHT
45890	Ø 246 × 27 mm	4 × 90° / Radius 110 mm	9.3 kg

Suitable slot keys: Item No. 452214 / 442218 (page 61)

Quick-Point® Single Plates for individual centre bore

A centre bore with individually selectable diameter and tolerance provides the option for access to rotary joints.

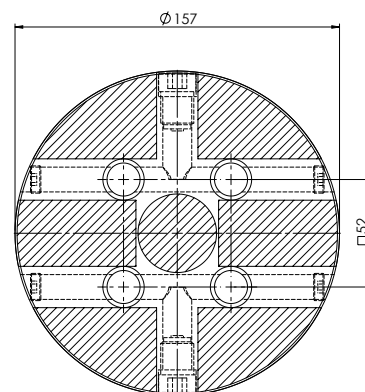

QUICK-POINT® 52, ROUND PLATE Ø 157 × 27 MM, FOR INDIVIDUAL CENTRE BORE

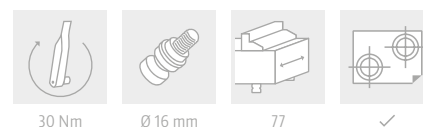

ITEM NO.	DIMENSIONS	MAX. Ø CENTRE BORE	WEIGHT
45903	Ø 157 × 27 mm	38 mm	3.7 kg
45004	Set mounting bores according to customer's request		
45002	Set keyways according to customer's request		
45009	Set centre bore according to customer's request		

Possible Modification of Quick-Point® Plate 45903



- 1 × Centre bore Ø 38 mm
- 1 × Keyway 20H7
- 4 × Mounting bores for M8 screws, incl. step for Ø 15 mm cover discs, for machine tables with 6 × 60° grooves

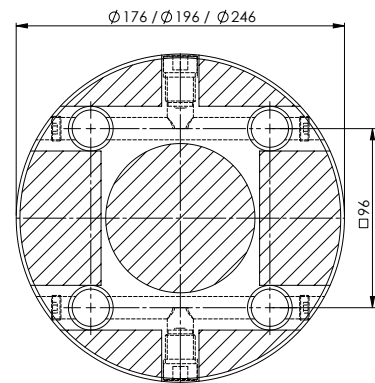

QUICK-POINT® 96, ROUND PLATES

Ø 176 / 196 / 246 × 27 MM, FOR INDIVIDUAL CENTRE BORE



30 Nm



Ø 20 mm



125



✓

ITEM NO.	DIMENSIONS	MAX. Ø CENTRE BORE	WEIGHT
45803	Ø 176 × 27 mm	80 mm	4.8 kg
45823	Ø 196 × 27 mm	80 mm	6.0 kg
45843	Ø 246 × 27 mm	80 mm	9.5 kg
45004	Set mounting bores according to customer's request		
45002	Set keyways according to customer's request		
45009	Set centre bore according to customer's request		

Possible Modification of Quick-Point® Plate 45823



- 1 × Centre bore Ø 80 mm
- 1 × 130H6 tapered fitting
- 4 × Mounting bores for M12 screws, incl. step for Ø 20 mm cover discs, for machine tables with 6 × 60° grooves

Quick-Point® Multi Plates

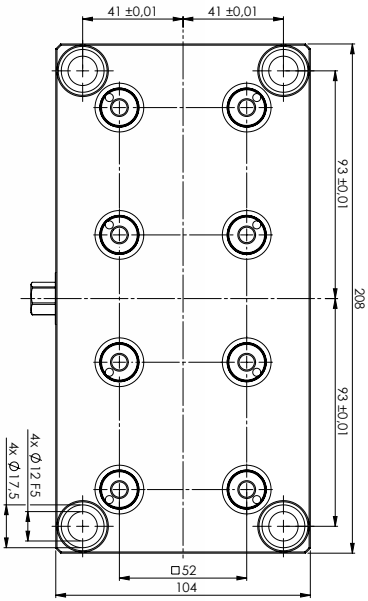

QUICK-POINT® 52, 2-FOLD GRID PLATE 208 × 104 × 27 MM

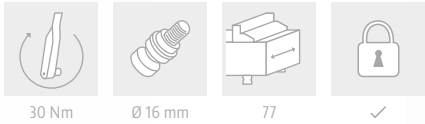

ITEM NO.	DIMENSIONS	MOUNTING BORES	WEIGHT
45621	208 × 104 × 27 mm	186 × 82 mm	4.0 kg

Suitable Quick-Lock: Item No. 45252 (page 58)

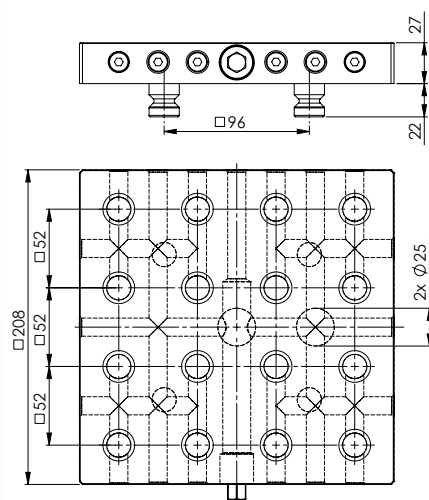

QUICK-POINT® 52, 4-FOLD GRID PLATE
208 × 208 × 27 MM, WITHOUT MOUNTING BORES

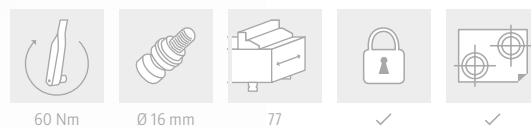

ITEM NO.	DIMENSIONS	WEIGHT
45640	208 × 208 × 27 mm	8.2 kg
45644	Set mounting bores according to customer's request	
45642	Set keyways according to customer's request	

Included in delivery: 4 × Quick-Point® clamping studs Ø 20 mm, for adapting the plate to the Quick-Point® 96 system
 Suitable Quick-Lock: Item No. 45452 (page 58)

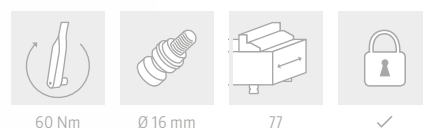
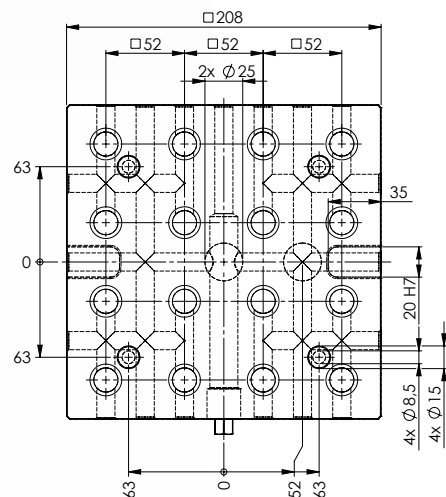

QUICK-POINT® 52, 4-FOLD GRID PLATE
208 × 208 × 27 MM, WITH MOUNTING BORES FOR 63 MM T-SLOT DISTANCE

ITEM NO.	DIMENSIONS	MOUNTING BORES	WEIGHT
45641	208 × 208 × 27 mm	for 63 mm t-slot distance	8.0 kg

Suitable Quick-Lock: Item No. 45452 (page 58)

Quick-Point® Multi Plates

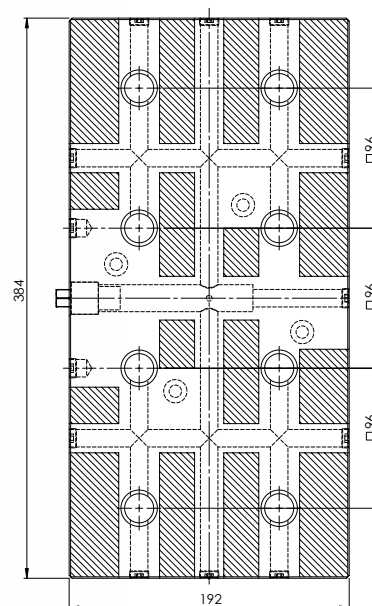

QUICK-POINT® 96, 2-FOLD GRID PLATE 384 × 192 × 27 MM, WITHOUT MOUNTING BORES

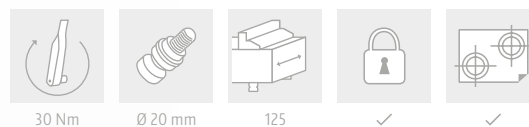

ITEM NO.	DIMENSIONS	WEIGHT
45720	384 × 192 × 27 mm	14.7 kg
45024	Set mounting bores according to customer's request	
45022	Set keyways according to customer's request	

Suitable Quick-Lock: Item No. 45296 (page 58)

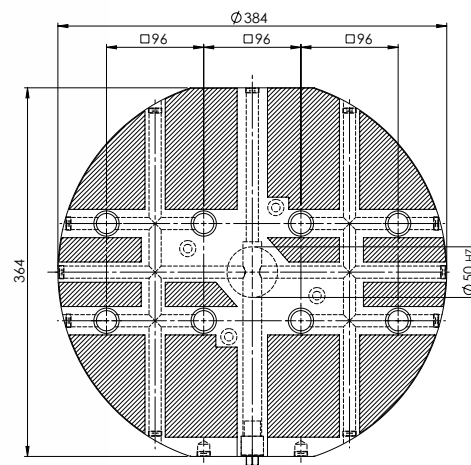

QUICK-POINT® 96, 2-FOLD GRID PLATE, ROUND Ø 384 × 27 MM, WITHOUT MOUNTING BORES



ITEM NO.	DIMENSIONS	WEIGHT
45962	Ø 384 × 27 mm	22.8 kg
45044	Set mounting bores according to customer's request	
45042	Set keyways according to customer's request	

Suitable Quick-Lock: Item No. 45996 (page 58)

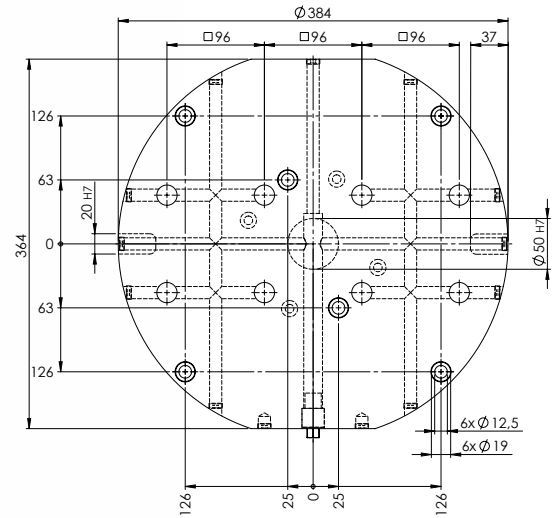

QUICK-POINT® 96, 2-FOLD GRID PLATE, ROUND
Ø 384 × 27 MM, WITH MOUNTING BORES FOR 63 MM T-SLOT DISTANCE

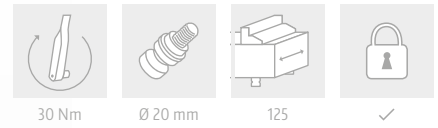

ITEM NO.	DIMENSIONS	MOUNTING BORES	WEIGHT
45963	Ø 384 × 27 mm	for 63 mm t-slot distance	22.4 kg

Suitable Quick-Lock: Item No. 45996 (page 58)

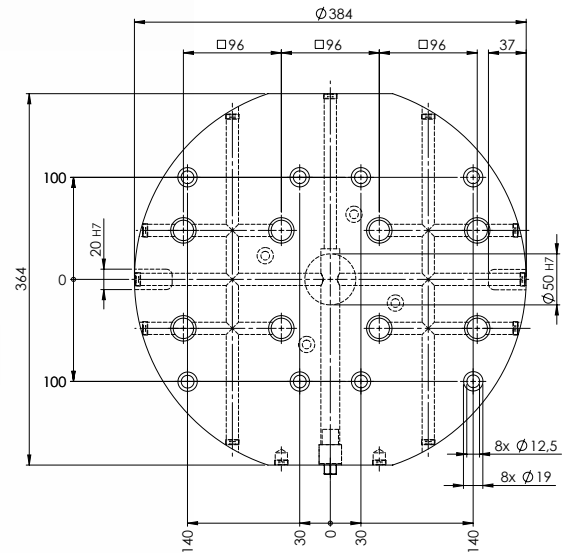

QUICK-POINT® 96, 2-FOLD GRID PLATE, ROUND
Ø 384 × 27 MM, WITH MOUNTING BORES FOR 100 MM T-SLOT DISTANCE

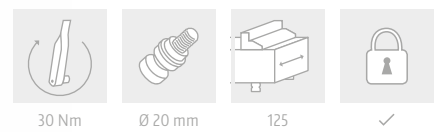

ITEM NO.	DIMENSIONS	MOUNTING BORES	WEIGHT
45964	Ø 384 × 27 mm	for 100 mm t-slot distance	22.4 kg

Suitable Quick-Lock: Item No. 45996 (page 58)

Quick-Point® Multi Plates

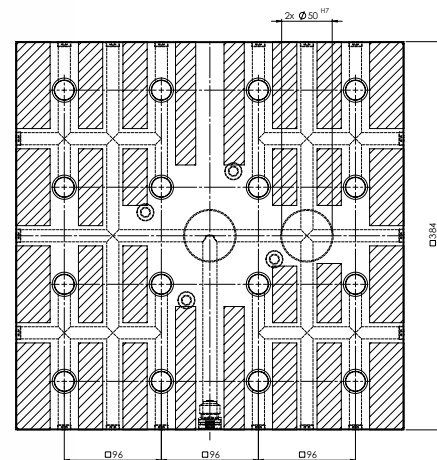

QUICK-POINT® 96, 4-FOLD GRID PLATE 384 × 384 × 27 MM, WITHOUT MOUNTING BORES



ITEM NO.	DIMENSIONS	WEIGHT
45740	384 × 384 × 27 mm	29.7 kg
45044	Set mounting bores according to customer's request	
45042	Set keyways according to customer's request	

Suitable Quick-Lock: Item No. 45496 (page 58)

Applications

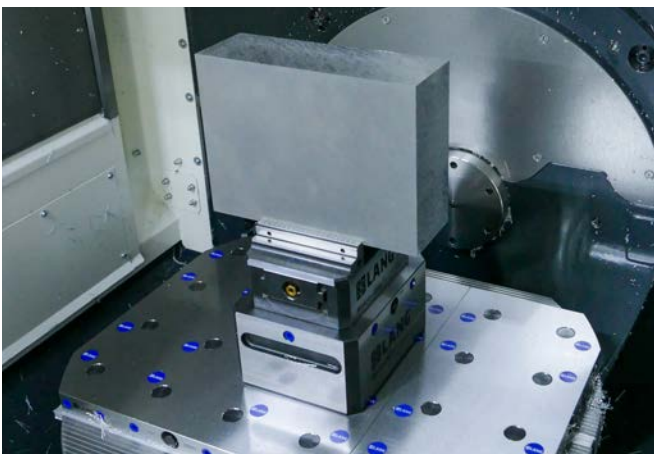
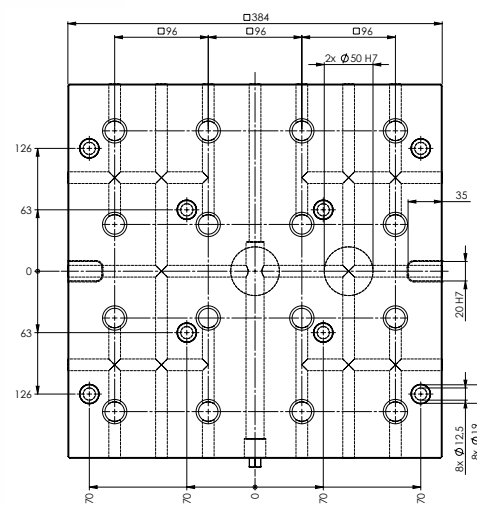

Image: Donner GmbH The Qualifactory

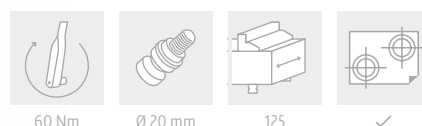

Image: Orrhaga Waterjet AB



QUICK-POINT® 96 4-FOLD GRID PLATE

384 × 384 × 27 MM, WITH MOUNTING BORES FOR 63 MM T-SLOT DISTANCE



ITEM NO.	DIMENSIONS	MOUNTING BORES	WEIGHT
45741	384 × 384 × 27 mm	for 63 mm t-slot distance	29.2 kg

Suitable Quick-Lock: Item No. 45496 (page 58)

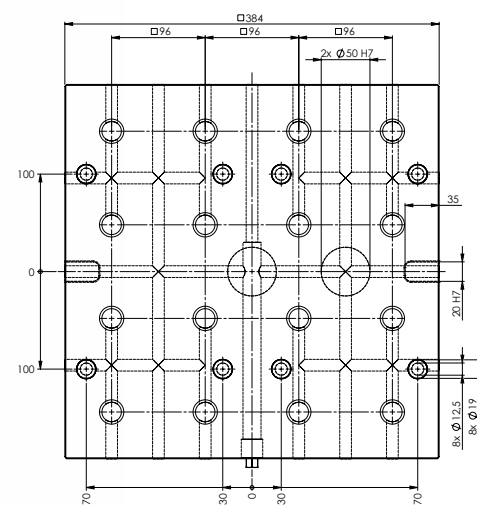

QUICK-POINT® 96, 4-FOLD GRID PLATE

384 × 384 × 27 MM, WITH MOUNTING BORES FOR 100 MM T-SLOT DISTANCE

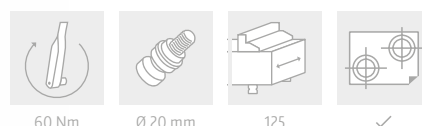

ITEM NO.	DIMENSIONS	MOUNTING BORES	WEIGHT
45742	384 × 384 × 27 mm	for 100 mm t-slot distance	29.2 kg

Suitable Quick-Lock: Item No. 45496 (page 58)

Quick-Point® Adaptor Plates

The adaptor plate emphasizes the modularity and versatility of the zero-point clamping system. This facilitates the change from the large 96 mm grid size to the small 52 mm grid size if the user has not only large but also small clamping devices in use. Here, and thanks to the raised position of the clamping device, the adaptor plate improves accessibility when machining small components.



Applications

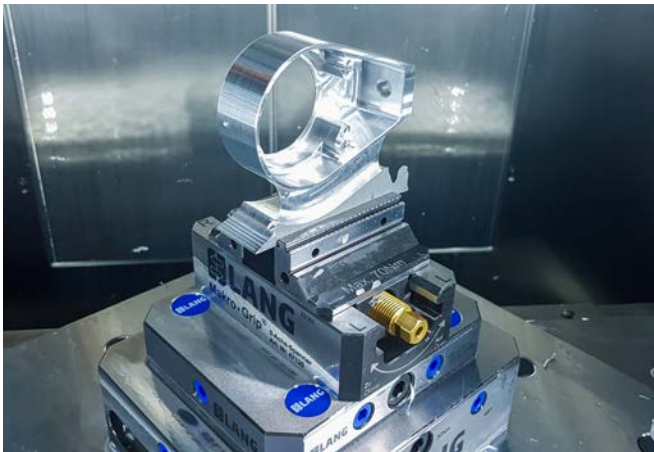

Image: Thoma Tec



Image: Ratiotechnik Milde GmbH
38



Image: Campagno Engineering

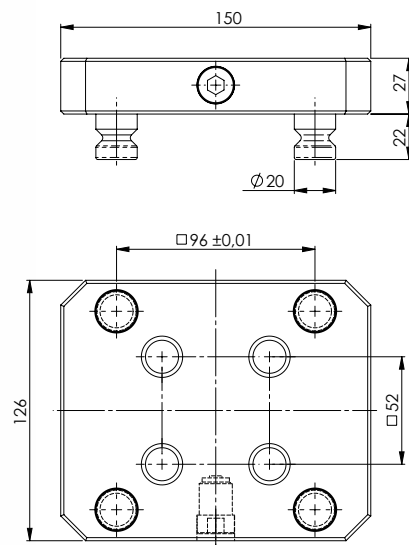

QUICK-POINT® ADAPTOR PLATE 150 × 126 × 27 MM

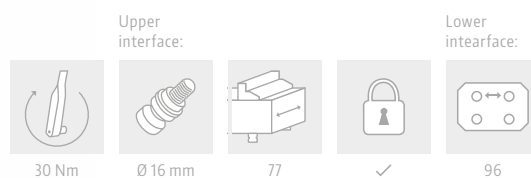

ITEM NO.	DIMENSIONS	WEIGHT
45160	150 × 126 × 27 mm	3.4 kg

Suitable Quick-Lock: Item No. 44552 (page 58)

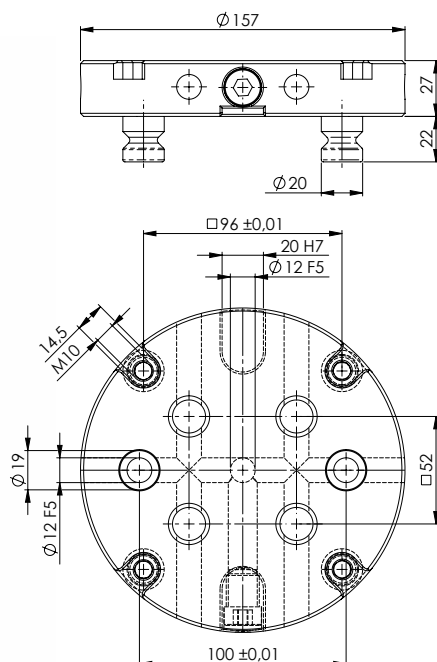

QUICK-POINT® ADAPTOR PLATE, ROUND Ø 157 × 27 MM

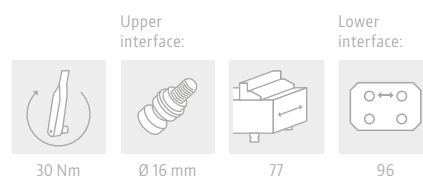

ITEM NO.	DIMENSIONS	WEIGHT
45910	Ø 157 × 27 mm	3.7 kg

Quick-Point® 5-Axis Risers

5-axis risers improve accessibility in 5-sided machining and extend, thanks to the integrated Quick-Point® mounting bolts on their underside the zero-point clamping system on the machine table quickly and precisely. In the robust, yet handy steel base body, vices, fixtures or workpieces are clamped directly.



This riser also features bores for Ø 20 mm clamping studs to use it as an adaptor for the 96 mm grid system.

Applications



Image: CNC-Manufaktur Brüssow GmbH & Co. KG

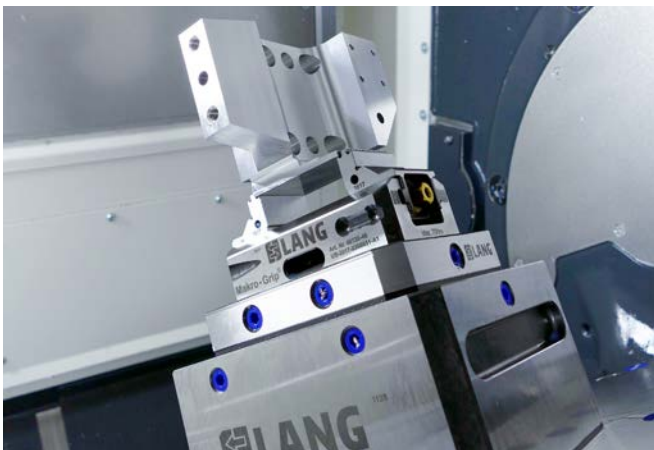
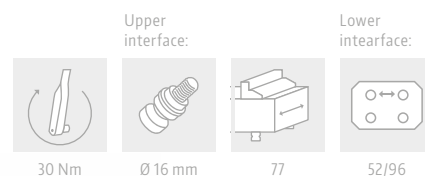
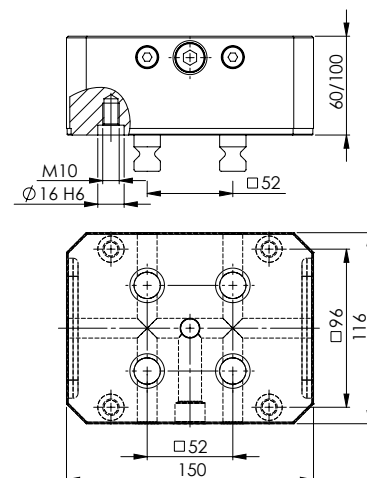

Image: Donner GmbH The Qualifactory
40



Image: Campagno Engineering



QUICK-POINT® 52, 5-AXIS RISER

ITEM NO.	DIMENSIONS	WEIGHT
45156	150 × 116 × 60 mm	6.1 kg
45157	150 × 116 × 100 mm	10.0 kg

Included: 4 × Quick-Point® clamping studs Ø 16 mm.
Suitable Quick-Lock: Item No. 44552 (page 58).

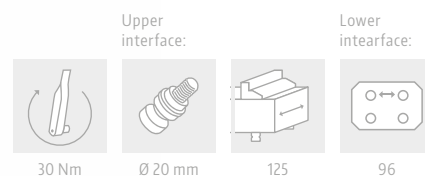
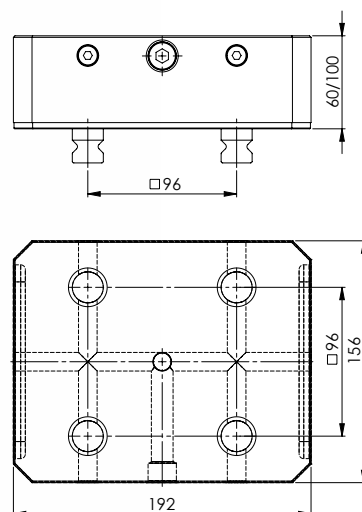

QUICK-POINT® 96, 5-AXIS RISER

ITEM NO.	DIMENSIONS	WEIGHT
45406	192 × 156 × 60 mm	11.2 kg
45407	192 × 156 × 100 mm	18.1 kg

Included: 4 × Quick-Point® clamping studs Ø 20 mm.
Suitable Quick-Lock: Item No. 44596 (page 58).

Quick-Point® Risers

A riser improves accessibility in 5-sided machining and can either be mounted directly and firmly on the machine table or set up and removed on a zero-point plate. It is available in round and rectangular versions in heights of 60 and 100 mm. The zero-point plates are pinned, aligned and mounted to the riser via bushings.

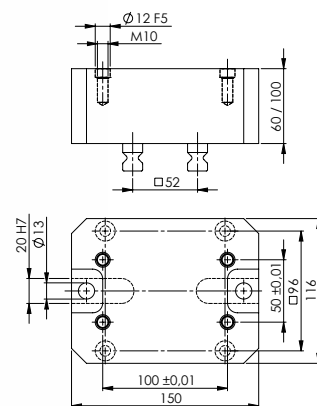

Upper interface



Ø 16 mm

Lower interface:



77



52/96

QUICK-POINT® 52, RISER

ITEM NO.	DIMENSIONS	WEIGHT
43060	150 × 116 × 60 mm	2.5 kg
43100	150 × 116 × 100 mm	4.2 kg

Suitable for Quick-Point® Plate, Item No. 45150.

Included: 4 × Quick-Point® clamping studs Ø 16 mm, 4 screws M 10 + 2 bushings Ø 12 × 12 mm (Item No. 45000-09).

This riser also features bores for Ø 20 mm clamping studs to use it as an adaptor for the 96 mm grid system.

Applications

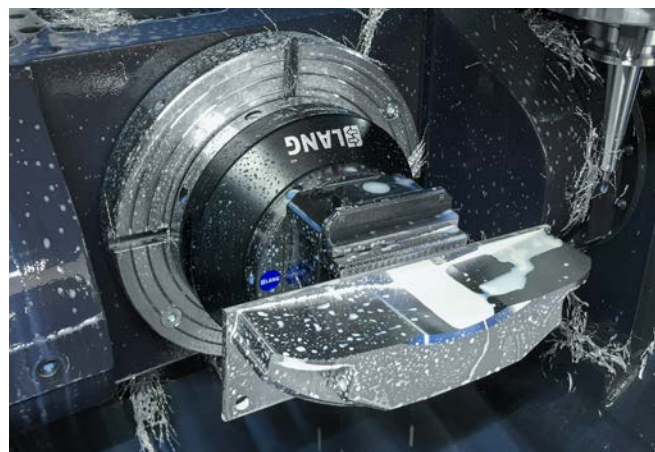
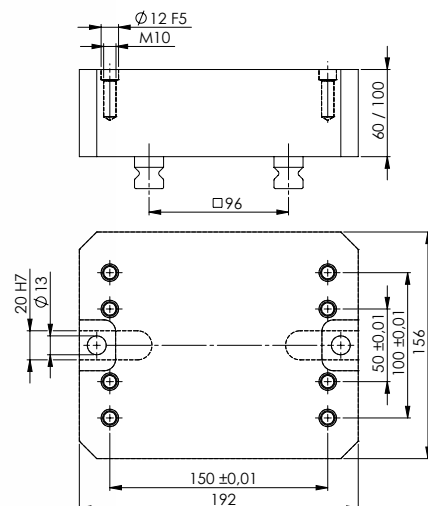

Image: Powerbrake SA



Upper interface:



Ø 20 mm

Untere Schnittstelle:



125



96

QUICK-POINT® 96, RISER

ITEM NO.	DIMENSIONS	WEIGHT
44060	192 × 156 × 60 mm	4.7 kg
44100	192 × 156 × 100 mm	7.9 kg

Suitable for Quick-Point® Plate, Item No. 45400.

Included: 4 × Quick-Point® clamping studs Ø 20 mm, 4 screws M 10 + 2 bushings Ø 12 × 12 mm (Item No. 45000-09).

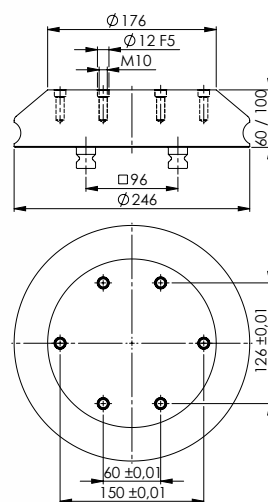

Upper interface:



Ø 20 mm

Lower interface:



125



96

QUICK-POINT® 96, RISER, ROUND

ITEM NO.	HEIGHT	DIAMETER	WEIGHT
44006	60 mm	bottom: 246 mm, top: 176 mm	6.6 kg
44010	100 mm	bottom: 246 mm, top: 176 mm	11.8 kg

Suitable for Quick-Point® plate Item No. 45800.

Included: 4 × Quick-Point® clamping studs Ø 20 mm, 6 screws M 10 + 2 bushings Ø 12 × 12 mm (Item No. 45000-09).

Individual mounting bores in the area of the flange possible.

Quick-Point® 3-face Pyramid

The high-strength, aluminium 3-face Pyramid with integrated Quick-Point® round plates is designed for increasing the run time of 5-axis machine tools.

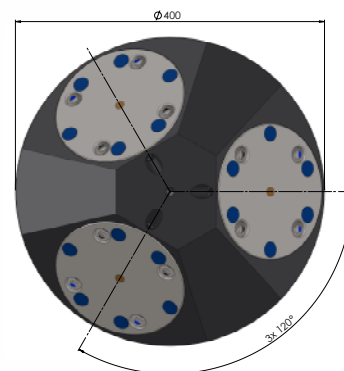
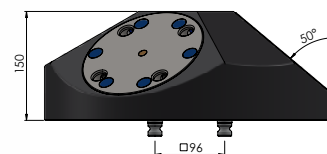

Upper interface:



30 Nm



Ø 20 mm



125

Lower interface:



96

QUICK-POINT® 96, 3-FACE PYRAMID

ITEM NO.	DIMENSIONS	WEIGHT
43400	Ø 400 × 150 mm	43.0 kg

Included: 4 × Quick-Point® clamping studs Ø 20 mm

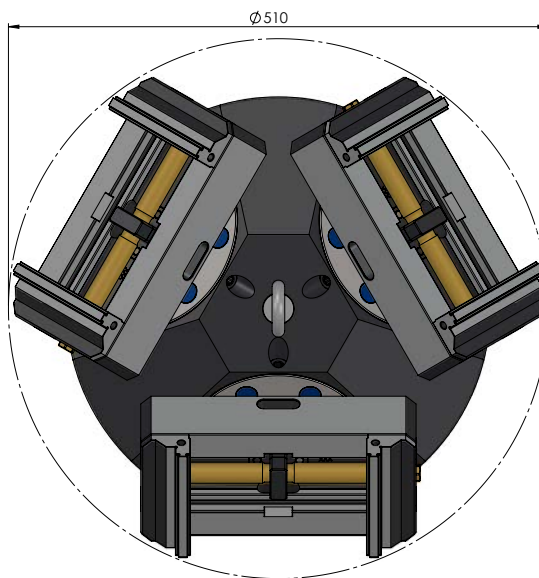
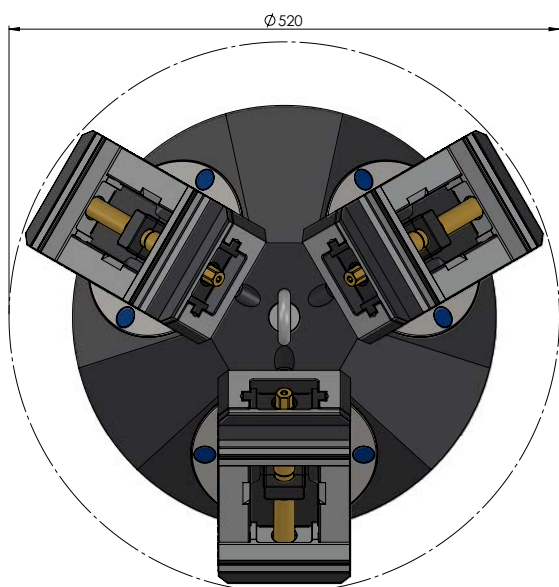

The 3-face Pyramid can accept Makro-Grip® 5-Axis Vices 125 with a maximum length of 210 mm when mounted vertically (left), whereas the maximum length is 260 mm when mounted horizontally (right).

Quick•Point® Twin Base

The hardened and ground Twin Base is ideal for manufacturing 5-axis parts with a 3-axis machine tool. Workpieces can be positioned $4 \times 90^\circ$ safely and with a high repeat accuracy.

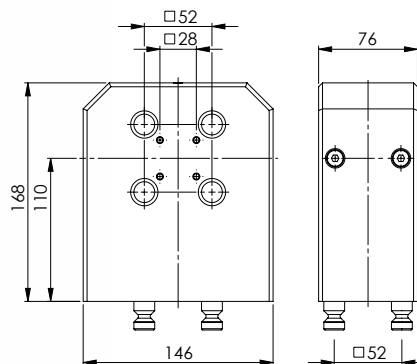

Upper interface:



30 Nm



Ø 16 mm



77

Lower interface:



52

QUICK•POINT® 52, TWIN BASE

ITEM NO.	DIMENSIONS	WEIGHT
47220	146 × 76 × 168 mm	13.9 kg

Suitable Quick-Lock: Item No. 44552 (page 58)

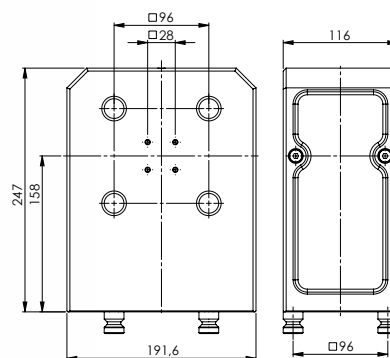

Upper Interface



30 Nm



Ø 20 mm



125

Lower Interface



96

QUICK•POINT® 96, TWIN BASE

ITEM NO.	DIMENSIONS	WEIGHT
47520	192 × 116 × 247 mm	27.8 kg

Suitable Quick-Lock: Item No. 44596 (page 58)

Quick-Point® MT3 3-face Tombstone

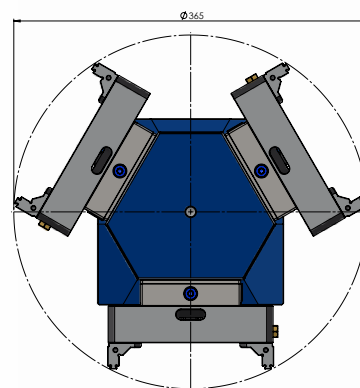
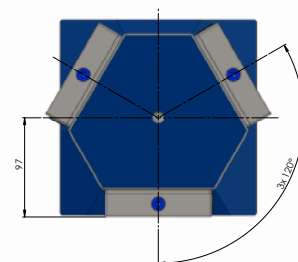
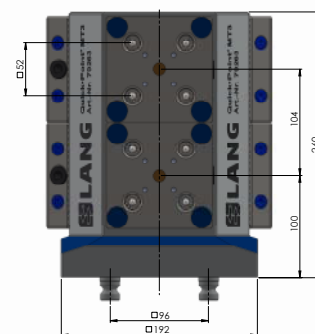
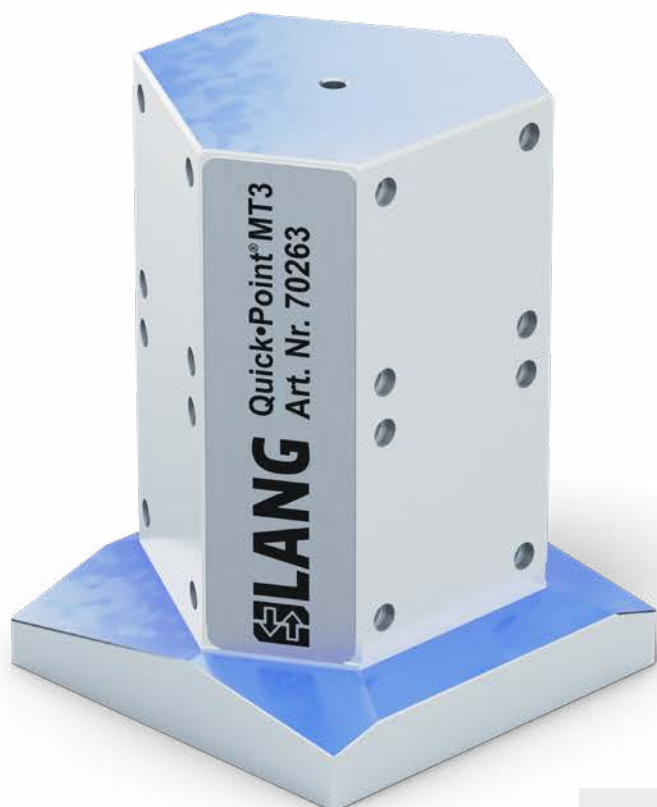

96

The 3-face Tombstone can accept all vices with a jaw width of 46 and 77 mm when mounted horizontally.

QUICK-POINT® MT3, 3-FACE TOMBSTONE

ITEM NO.	DIMENSIONS	MAX. QTY OF GRID PLATES	WEIGHT
70263	192 × 192 × 260 mm	6 × 75600 or 3 × 45621	44.8 kg

Included: 4 × Quick-Point® clamping studs Ø 20 mm

Suitable Quick-Point® Plate for both Tombstones:



QUICK-POINT® 52 GRID PLATE, 104 × 104 × 27 MM

ITEM NO.	DIMENSIONS	MOUNTING BORES	WEIGHT
75600	104 × 104 × 27 mm	82 × 82 mm	1.8 kg

Drawing on page 20.



30 Nm

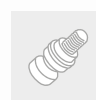

Ø 16 mm



77

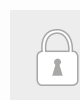

✓

Quick·Point® MT4 4-face Tombstone

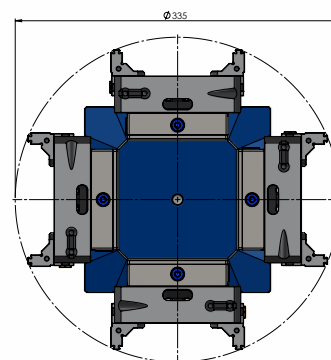
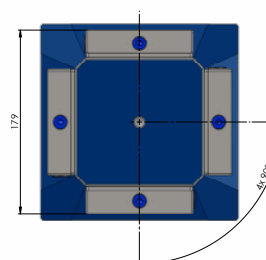
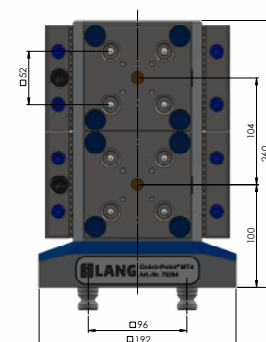

96

The 4-face Tombstone can accept vices (jaw width 46 / 77) with a max. base length of 130 mm when mounted horizontally.

QUICK·POINT® MT4, 4-FACE TOMBSTONE

ITEM NO.	DIMENSIONS	MAX. QTY OF GRID PLATES	WEIGHT
70264	192 × 192 × 260 mm	8 × 75600 or 4 × 45621	37.7 kg

Included: 4 × Quick·Point® clamping studs Ø 20 mm

Suitable Quick·Point® Plate for both Tombstones:



QUICK·POINT® 52 2-FOLD GRID PLATE, 208 × 104 × 27 MM

ITEM NO.	DIMENSIONS	MOUNTING BORES	WEIGHT
45621	208 × 104 × 27 mm	186 × 82 mm	4.0 kg

Drawing on page 32.



30 Nm



Ø 16 mm



77



✓

Quick-Tower – The zero-point clamping system for horizontal machining centres

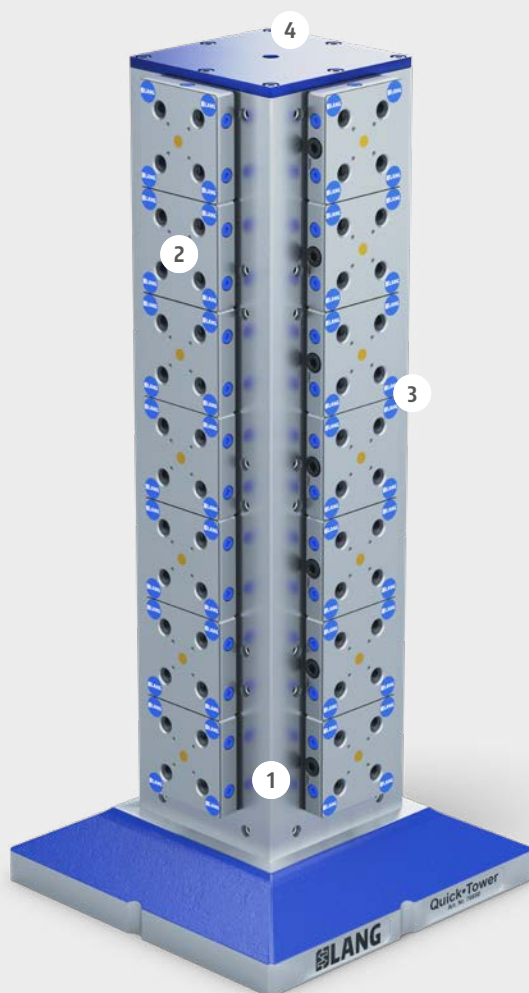

- 1 Stable and sturdy cast body with a plane parallelism of ± 0.02 mm
- 2 Up to 28 \times Quick-Point® Grid Plates 52 and 16 \times Quick-Point® Grid Plates 96 can be mounted depending on the size of the Quick-Tower
- 3 Continuous zero-point grid on all four faces
- 4 Included in delivery: Eye bolt for transport via crane
- 5 Equipped with 12 \times Quick-Point® clamping studs $\varnothing 20$ mm



Mounting options

For mounting the Quick-Tower onto the machine tool table there are three options:

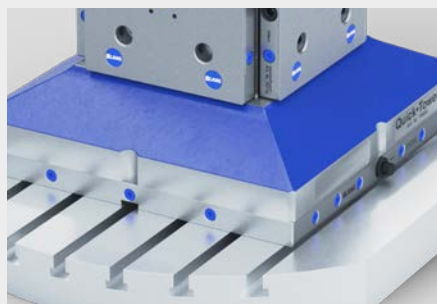

Mounted to the Quick-Point® system
(e.g. 4-fold Grid Plate 96)

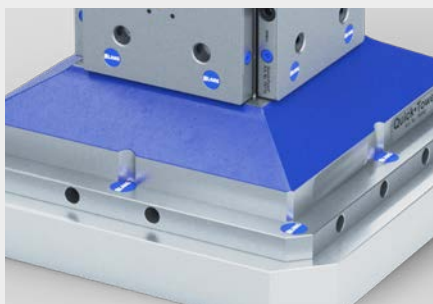

Mounted to the Quick-Tower Universal
Base Plate (see page 51)

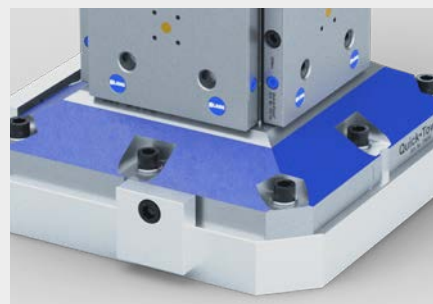

Mounted directly to the machine table with
custom bores (price upon request!)

Applications

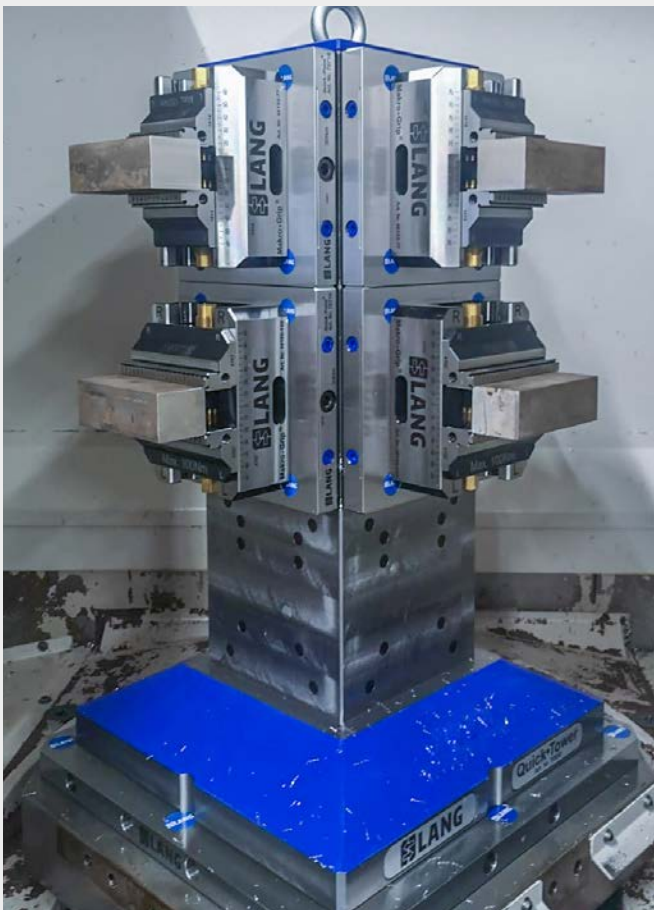
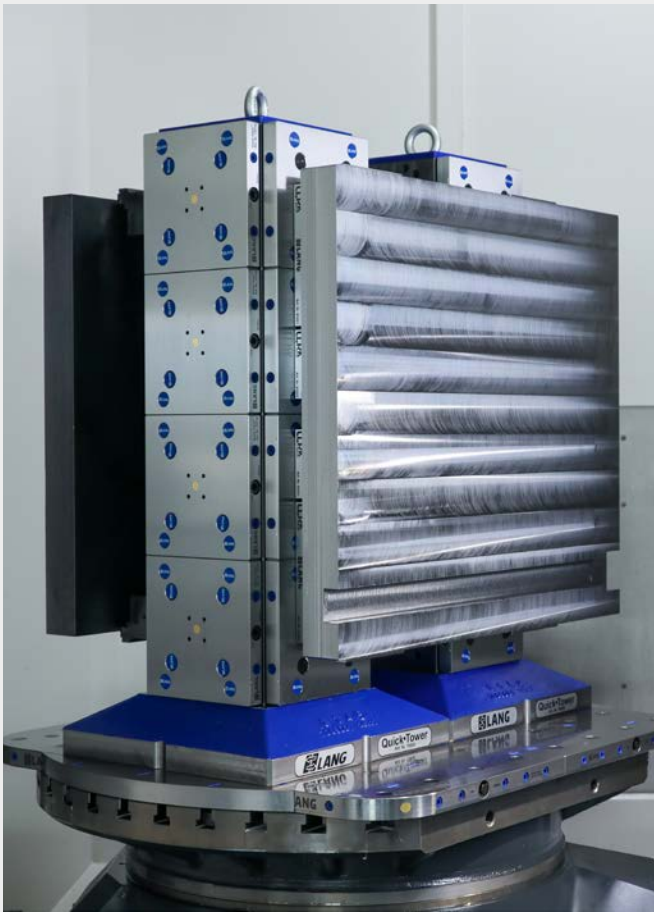

Quick-Tower Base Body

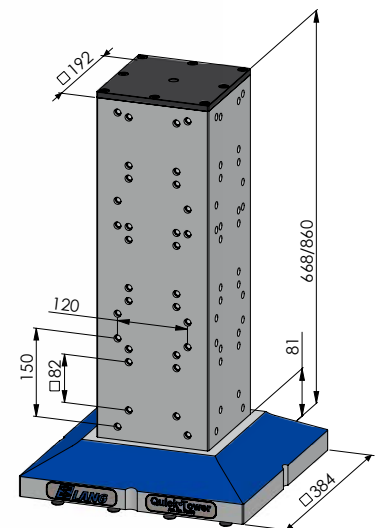
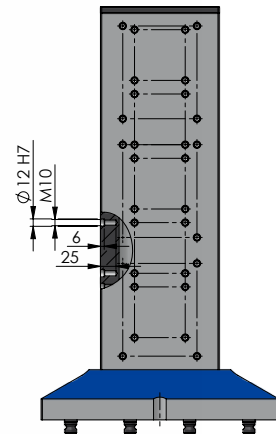
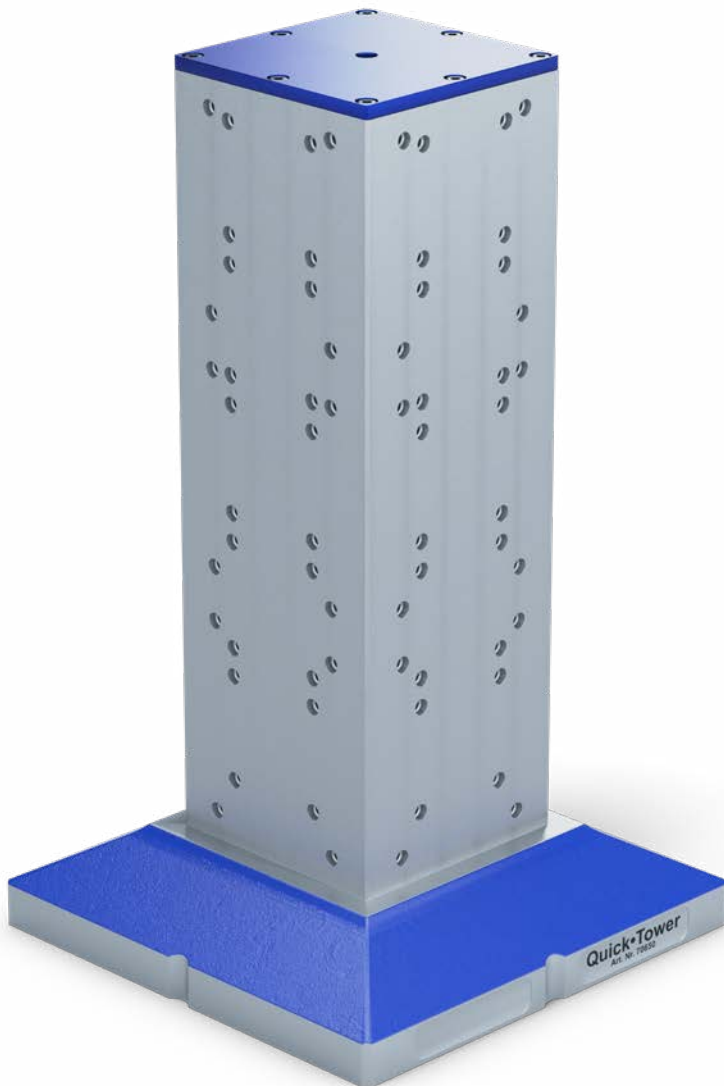

Grid of 150 × 120 mm is designed to mount Quick-Point® plates 75710.

Grid of 82 × 82 mm is designed to mount Quick-Point® plates 75600.

QUICK-TOWER BASE BODY

ITEM NO.	BODY DIMENSIONS	BASE DIMENSIONS	TOTAL HEIGHT	WEIGHT
70650	192 × 192 mm	384 × 384 mm	668 mm	160 kg
70850	192 × 192 mm	384 × 384 mm	860 mm	200 kg

If you prefer to fix the tombstone directly onto the machine tool table/pallet using its threads or slots just ask for an individual quotation.

Quick-Tower **Universal Base Plate**



**QUICK-TOWER UNIVERSAL BASE PLATE,
THROUGH BORE Ø 50H7, WITHOUT MOUNTING BORES**

ITEM NO.	DIMENSIONS	MOUNTING BORES	WEIGHT
70005	396 × 396 × 27 mm	–	32.5 kg
70006	Set mounting bores according to customer's request		

Drawing to be found on our website www.lang-technik.de



**QUICK-TOWER UNIVERSAL BASE PLATE,
THROUGH BORE Ø 50H7, WITH MOUNTING BORES**

ITEM NO.	DIMENSIONS	MOUNTING BORES	WEIGHT
70008	446 × 446 × 27 mm	12 × M16 at 200 mm distance	39.5 kg

Drawing to be found on our website www.lang-technik.de

Utilisation and mounting:

These sub-plates act as an interface between the machine table and the Quick-Tower. This allows the utilisation of one standard Quick-Tower in different machine tools and/or on different pallets.

The sub-plate can be aligned concentrically using the plate's Ø 50H7 through bore and the table's/pallet's centre bore accordingly. The axial alignment can be done by probing the outer faces or adding keyways for T-slot keys. The base plate is mounted to the table/pallet with DIN EN ISO 4762 cylinder screws. The fixation of the Quick-Tower is done with 12 × M16 threaded pins that are located in the four lateral faces of the base plate. These pins fix the Quick-Tower into position strongly with Quick-Point® clamping studs.

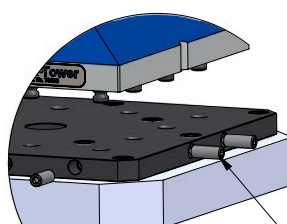

Threaded pin
12 × M16

Quick-Tower Grid Plates

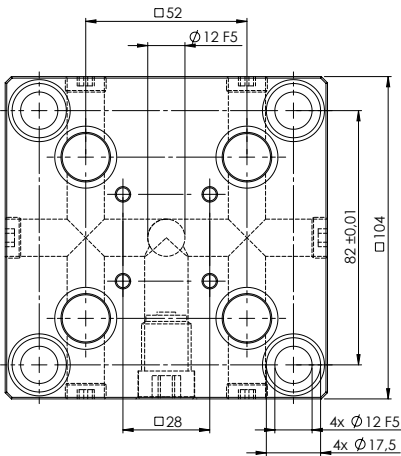

QUICK-TOWER 52, GRID PLATE 104 × 104 × 27 MM

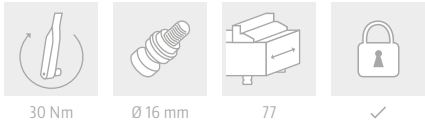

ITEM NO.	DIMENSIONS	MOUNTING BORES	WEIGHT	QUANTITY
75600	104 × 104 × 27 mm	82 × 82 mm	1.8 kg	1 - 10
				11 - 25
				26 - 49
				from 50

*Block pricing only applies for a purchase of a Quick-Tower.
Included: 4 screws M 10 × 35, 2 bushings Ø 12 × 12 mm (Item No. 45000-09).

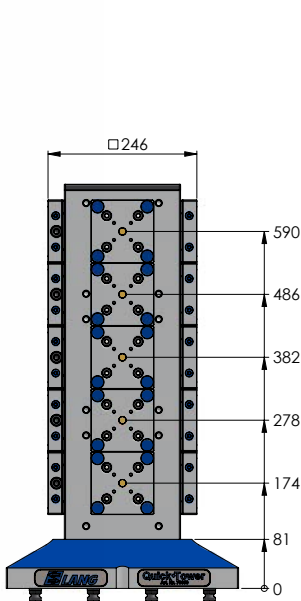

Tower 70650, height 668 mm,
max. 5 pallets on each face.

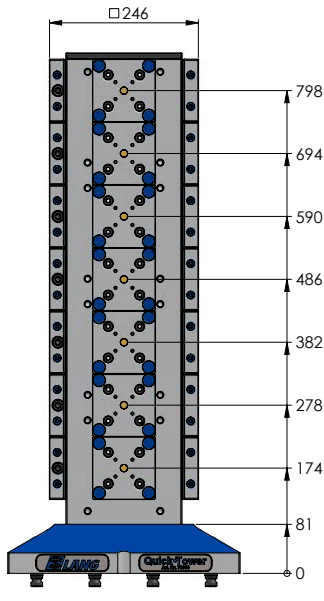

Tower 70850, height 860 mm,
max. 7 pallets on each face.

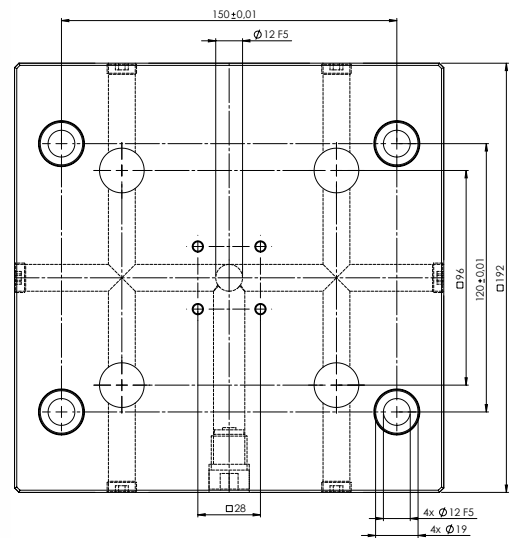

QUICK-TOWER 96, GRID PLATE

192 × 192 × 27 MM

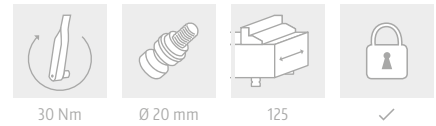

ITEM NO.	DIMENSIONS	MOUNTING BORES	WEIGHT	QUANTITY
75710	192 × 192 × 27 mm	150 × 120 mm	7.0 kg	1 – 6
				7 – 11
				12 – 29
				from 30

*Block pricing only applies for a purchase of a Quick-Tower.
Included: 4 screws M 10 × 35, 2 bushings Ø 12 × 12 mm (Item No. 45000-09).

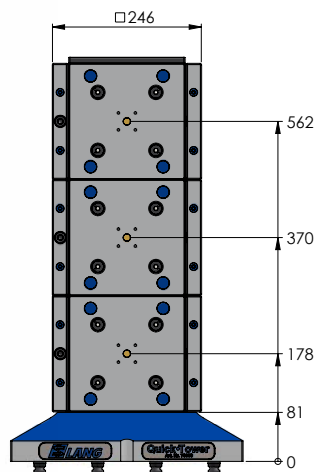
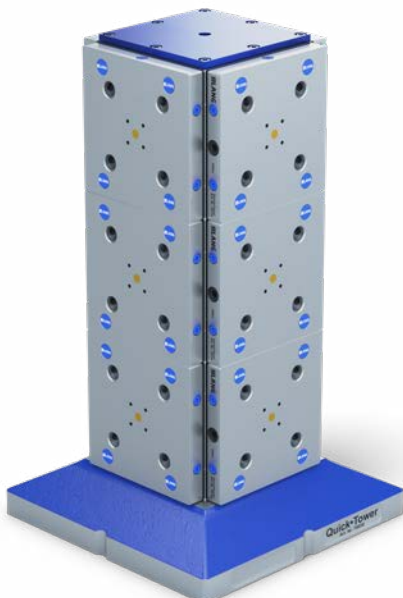

Tower 70650, height 668 mm,
max. 3 pallets on each face.

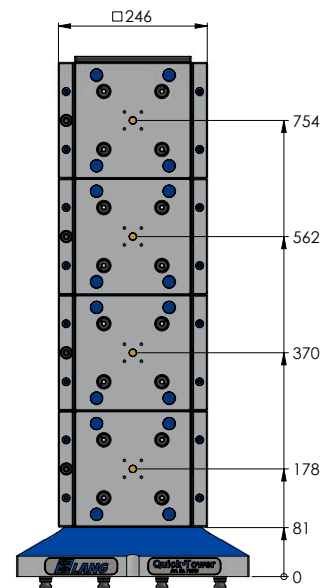

Tower 70850, height 860 mm,
max. 4 pallets on each face.

Quick-Point® Clamping Studs

For individual adaptation of fixtures, workpieces or existing vices onto our Quick-Point® zero-point clamping system.



QUICK-POINT® CLAMPING STUDS FOR INDIVIDUAL ADAPTATION

ITEM NO.	DESCRIPTION	UNIT
45270	Ø 16 mm for 52 mm spacing, incl. M 8 threaded pin	1 pc.
45570	Ø 20 mm for 96 mm spacing, incl. M 10 threaded pin	1 pc.

Please note: 4 Clamping Studs are required for one Quick-Point® plate!

How it works:

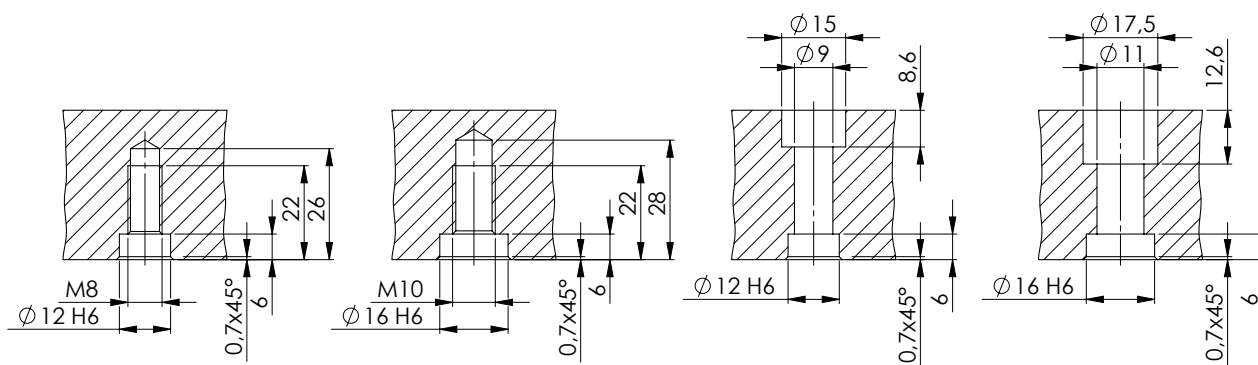

with threaded pins

with screws

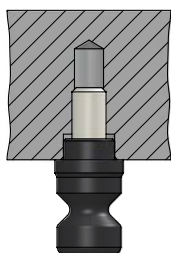

52

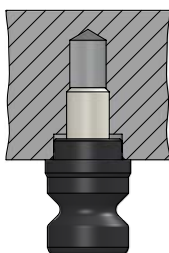

96

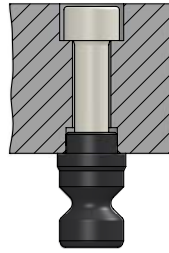

52

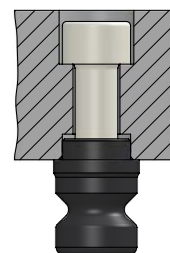

96

Applications:

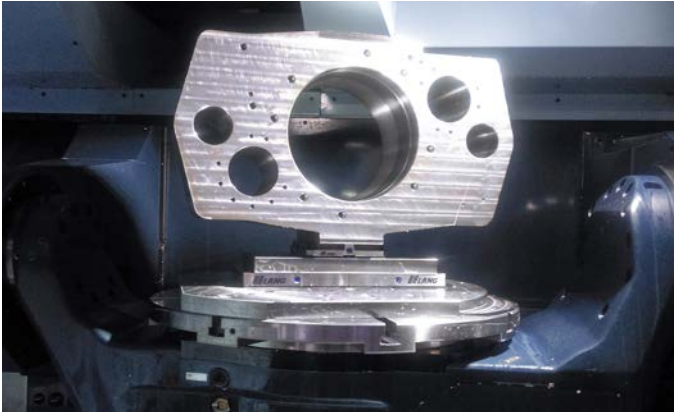

The studs need to be positioned in a 52 mm / 96 mm (± 0.01 mm) spacing for clamping workpieces straight onto the Quick-Point® plates.



The workpiece is clamped securely, without a vice, directly into the zero-point system.

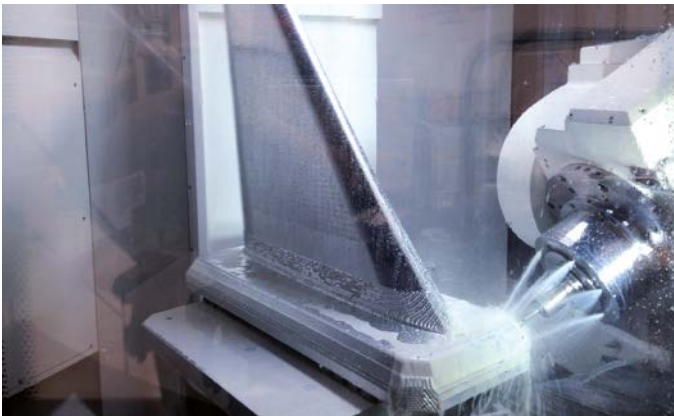

Aluminium part (weight: 1.315 kg, dimensions: $1.067 \times 406 \times 1.016$ mm) clamped with 16 clamping studs.

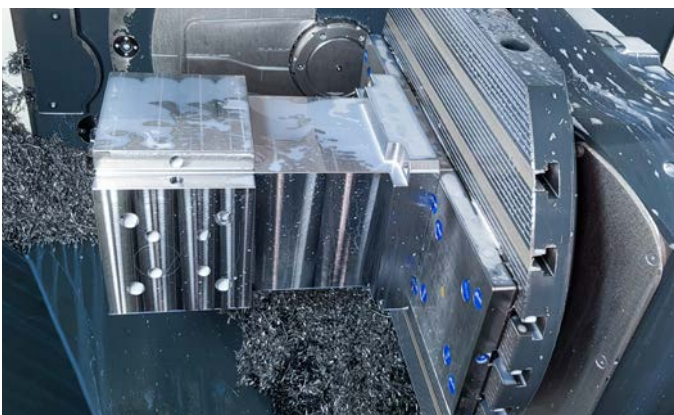

Not only highly precise but also extremely rigid: Workpiece with 200 kg weight, 500 mm height. Clamped with just 4 studs in a single Quick-Point® plate.

Quick-Point® Support Plates

Support plates made of non-hardened steel – for individual adaptation of fixtures and other devices.

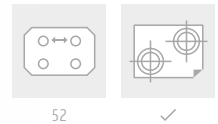

QUICK-POINT® 52, SUPPORT PLATES

ITEM NO.	DIMENSIONS	WEIGHT
45275	96 × 96 × 27 mm	2.0 kg
45277	156 × 156 × 27 mm	5.2 kg

Included: 4 × Quick-Point® clamping studs Ø 16 mm



QUICK-POINT® 96, SUPPORT PLATES

ITEM NO.	DIMENSIONS	WEIGHT
45575	156 × 156 × 27 mm	5.3 kg
45577	192 × 192 × 27 mm	8.3 kg

Included: 4 × Quick-Point® clamping studs Ø 20 mm

Quick-Point® Spacer Studs

Spacer studs allow for through holes in material which is clamped directly in the zero-point system. It also improves accessibility when machining edges and angles.



QUICK-POINT® SPACER STUDS

ITEM NO.	DIAMETER	SPACER HEIGHT	UNIT
45270-10	Ø 16 mm for 52 mm spacing	10 mm (Ø 24 mm)	1 Set (4 pcs.)
45570-10	Ø 20 mm for 96 mm spacing	10 mm (Ø 28 mm)	1 Set (4 pcs.)

Applications



Quick-Point® Quick-Lock Fast Actuation System

Mechanical and quick fastener, compatible with all rectangular and squared Quick-Point® plates. Also compatible with the Quick-Point® 96, 2-fold Grid Plate, round. With the Quick-Lock, we provide a clamping lever and washers to adjust clamping force as needed.



QUICK-POINT® QUICK-LOCK 52

ITEM NO.	DESCRIPTION	FOR ITEM NO.	WEIGHT
44552	Quick-Lock for Quick-Point® 52 Single-Plates, Twin Base 52, Adaptor Plate, 5-Axis Riser 52	45600 / 75600 / 45150 / 45151 / 47220 / 45160 / 45156 / 45157	0.3 kg
45252	Quick-Lock for Quick-Point® 52, 2-fold Grid Plate	45621	0.8 kg
45452	Quick-Lock for Quick-Point® 52, 4-fold Grid Plate	45640 / 45641	0.9 kg

QUICK-POINT® QUICK-LOCK 96

ITEM NO.	DESCRIPTION	FOR ITEM NO.	WEIGHT
44596	Quick-Lock for Quick-Point® 96 Single-Plates, Twin Base 96, Adaptor Plate, 5-Axis Riser 96	45710 / 45763 / 45715 / 45716 / 45400 / 45401 / 47520 / 45406 / 45407	0.4 kg
45296	Quick-Lock for Quick-Point® 96, 2-fold Grid Plate	45720	0.9 kg
45996	Quick-Lock for Quick-Point® 96, 2-fold Grid Plates, round	45962 / 45963 / 45964	0.9 kg
45496	Quick-Lock for Quick-Point® 96, 4-fold Grid Plates	45740 / 45741 / 45742	1.0 kg

Easy assembly in a few steps

Within just a few seconds the Quick-Lock fast actuation system is mounted to a Quick-Point® Plate. With a 180° motion of the lever the Quick-Lock clamps and releases the vice.



Removal of the Quick-Point® actuation screw:

Remove actuation screw and the two plastic covers and keep them safe. With multi fold plates you also have to remove the actuation bolt. During the whole installation process the Quick-Point® plate does not have to be removed from the machine table if already mounted.



Installation of the Quick-Lock fastener:

Insert the Quick-Lock pressure bolt into the actuation screw channel and tighten the two screws.



Checking the clamping forces:

Insert the clamping lever into the clamping element of the Quick-Lock fastener. Move the clamping lever in a 180° motion from right to left until you feel resistance. If the remaining angle is more/less than 70°, the clamping force needs to be adjusted by adding/removing washers. Detailed instructions and videos can be found on our website www.lang-technik.de.

Quick-Lock utilisation

The clamping lever equipped with a rotation lock can be used both horizontally and vertically. For vices and fixtures protruding from the Quick-Point® plate, the lever is used horizontally (right picture).



Quick-Point® Accessories



QUICK-POINT® COVER DISCS, PLASTIC

ITEM NO.	DIAMETER	UNIT
45008-15	Ø 15 mm	1 set (20 pcs.)
45008-20	Ø 20 mm	1 set (20 pcs.)
45008-27	Ø 27 mm	1 set (20 pcs.)

Heat-resistant, fibreglass reinforced cover discs for protecting the mounting screws against material pollution.



QUICK-POINT® COVER PLUGS, PLASTIC

ITEM NO.	DIAMETER	UNIT
45052-20	Ø 16 mm for 52 mm spacing	1 set (4 pcs.)
45096-20	Ø 20 mm for 96 mm spacing	1 set (4 pcs.)

Cover plugs made of plastic for the protection of Quick-Point® 52 and Quick-Point® 96 holes when not in use. For multi fold plates steel plugs (see below) are necessary.



QUICK-POINT® COVER PLUGS, STEEL

ITEM NO.	DIAMETER	UNIT
45052-30	Ø 16 mm for 52 mm spacing	1 set (4 pcs.)
45096-30	Ø 20 mm for 96 mm spacing	1 set (4 pcs.)

Cover plugs made of steel spread the increased clamping force of multi grid plates evenly and protect stud holes not in use. They can be removed from plates with the Cover Plug Remover.



QUICK-POINT® COVER PLUG REMOVER

ITEM NO.	DESCRIPTION
45000-30	Cover Plug Remover

Comfortable grip with magnet for removing steel plugs from the Quick-Point® plates.



QUICK-POINT® HANDLE BAR, ALUMINIUM

ITEM NO.	DESCRIPTION
66605	
46081	Handle Bar

This handle bar facilitates the handling of Quick-Point® devices when setting up and dismantling. As with usual LANG clamping devices, the handle bar is clamped with two Quick-Point® 96 clamping studs in the zero-point system and is thereby especially suited for the transportation of heavier Quick-Point® products.

Quick-Point® Alignment



SLOT KEYS, LOOSE, DIN 6323, FOR AXIAL ALIGNMENT OF QUICK-POINT® PLATES

ITEM NO.	SIZE	UNIT
452014	20 to 14 mm	1 pc.
452018	20 to 18 mm	1 pc.

To make the assembly and alignment of the Quick-Point® plates as easy as possible, we offer slot keys for the plates' 20H7 keyways matching your table's t-slots (14 or 18 mm).

Attention: Keys not suitable for Item No. 45800 and 45890!

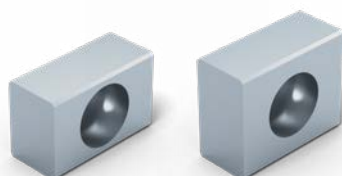

SLOT KEYS FOR AXIAL ALIGNMENT OF QUICK-POINT® ROUND PLATE, ITEM NO. 45890 (PAGE 29)

ITEM NO.	DIMENSIONS	UNIT
452214	14 × 22 mm	1 pc.
452218	18 × 22 mm	1 pc.

For the alignment of Quick-Point® plate, Item No. 45890, which has 14 & 18 H7 grooves in the bottom, we offer these keys. Grooves and keys are equipped with a M6 thread, suitable for screws DIN 84 or DIN 912, M6 × 16.



CENTRING STUDS FOR CONCENTRIC ALIGNMENT OF QUICK-POINT® PLATES

ITEM NO.	SIZE	UNIT
451230	12 to 30 mm	1 pc.
451232	12 to 32 mm	1 pc.
451250	12 to 50 mm	1 pc.
452530	25 to 30 mm	1 pc.
452532	25 to 32 mm	1 pc.
452550	25 to 50 mm	1 pc.
455030	50 to 30 mm	1 pc.
455032	50 to 32 mm	1 pc.
455050	50 to 50 mm	1 pc.

For the concentric alignment of Quick-Point® plates via fitting bores in the bottom (12, 25, 50 mm) we offer centring studs for the most common machine table holes (30, 32, 50 mm).

BUSHINGS FOR THE ALIGNMENT OF VICES AND ZERO-POINT PLATES



ITEM NO.	DIMENSIONS	FOR SCREW SIZE	UNIT
45000-09	Ø 12 × 12 mm	M 10	1 pc.
65191-04	Ø 12 × 12 mm	M 8	1 pc.
65191-05	Ø 16 × 15 mm	M 10	1 pc.

Item No. 45000-09 is suitable for aligning Quick-Point® plates on aluminum risers, Quick-Tower tombstones and other, select applications. Bushings 65191-04 and 65191-05 are used for the alignment and mounting of Makro-Grip® 5-Axis Vices on (old) LANG automation support pallets Item No. 65190 and 65197.

Quick·Point® Gauging Pallet

Jig-ground gauging pallet for a quick and precise alignment of Quick·Point® plates.
Recommended especially for rotary tables or chucks.

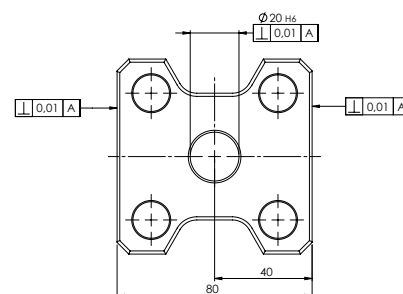
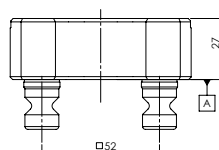
NEW VERSION

QUICK·POINT® 52 GAUGING PALLET

ITEM NO.	FOR	DIMENSIONS	MEASURING LENGTH	WEIGHT
44522	Quick·Point® 52	80 × 80 × 27 mm	70 mm per side	1.2 kg

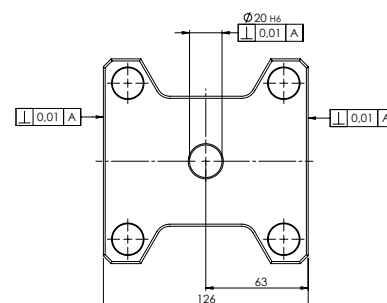
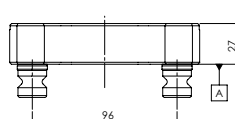
NEW VERSION

QUICK·POINT® 96 GAUGING PALLET

ITEM NO.	FOR	DIMENSIONS	MEASURING LENGTH	WEIGHT
44962	Quick·Point® 96	126 × 126 × 27 mm	116 mm per side	2.8 kg

How it works:

After clamping the gauging pallet in a Quick·Point® plate is done by probing the jig-ground sides of the gauging pallet. For concentric alignment the inner diameter of the gauging pallet can be used.



Quick·Point® Alignment Gauge

For easy and quick assembly of the Quick·Point® Grid Plates we recommend using the alignment gauge.
The precise alignment and dimensional accuracy of the plates is guaranteed.

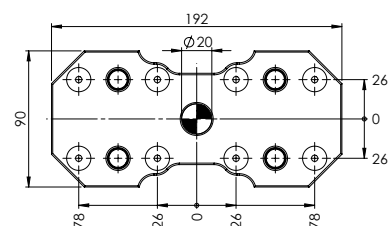

ALIGNMENT GAUGE 52 FOR QUICK·POINT® GRID PLATES

ITEM NO.	DESCRIPTION	WEIGHT
44152	Ausrichtlehre 52	3.4 kg
44152-10	Alignment gauge 52 for rent	-

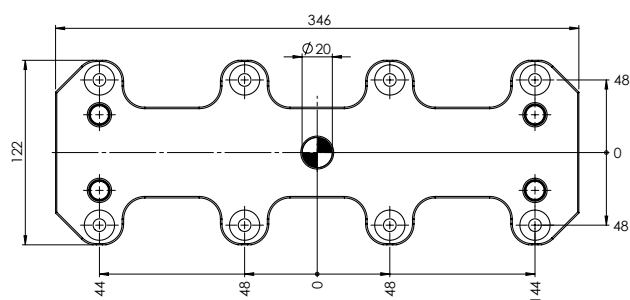

ALIGNMENT GAUGE 96 FOR QUICK·POINT® GRID PLATES

ITEM NO.	DESCRIPTION	WEIGHT
44196	Alignment gauge 96	6.5 kg
44196-10	Alignment gauge 96 for rent	-

How it works:

The Quick·Point® Alignment Gauge guarantees an accurate alignment of two or more Grid Plates positioned next to each other. This ensures that vices and fixtures can be clamped across two different plates. After the first plate is placed on the table, aligned with a probe and the screws fixed, the alignment gauge is applied on the neighboring plates and the outer accessible fixing screws can be tightened.



Quick·Point® Service

Set mounting bores

All of our Quick·Point® plates with prefabricated mounting bores are also available without such. The case-hardened zero-point plates (57 HRC, 0.7 mm deep) can be drilled according to the t-slots of the machine table. We offer this as a service.

The drawings of the Quick·Point® plates without mounting bores in this catalogue show hatched areas. These areas can be

used for mounting bores. On rare occasions mounting bores can even be set through rod channels. If this might be required for your application please ask your local LANG contact person.

All drawings and models, as well as video that explain the Quick·Point® plates are mounted to the machine table are available on our website www.lang-technik.de



Quick·Point® plate with prefabricated mounting bores.



Same Quick·Point® plate without mounting bores. These can be installed by LANG or the customer.

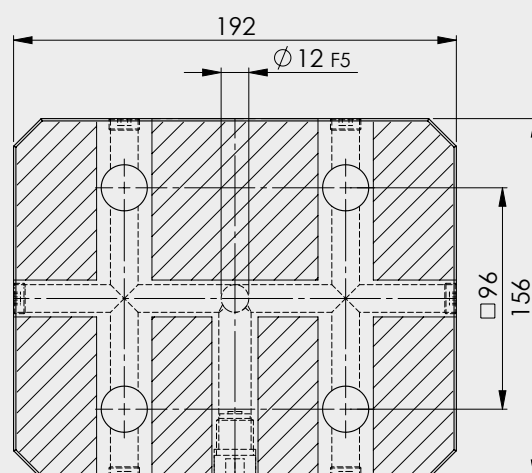

M5 Index bores

Inserting a threaded pin or screw ensures that LANG clamping devices (with an equivalent recess on the bottom) are always positioned in the correct way on the zero-point plate.

By default index bores are included in following plates:
Item No. 45150, 45400, 75600, 75710, 47220 and 47520.

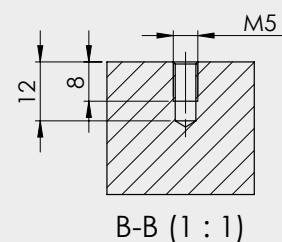
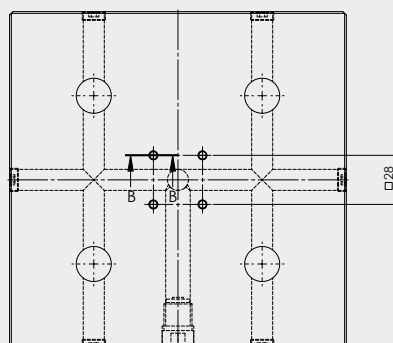

Covering mounting bores



Quick-Point® plate with plastic cover discs.

Mounting bores in Quick-Point® plates, either prefabricated or customised by LANG, have a 2.1 mm step. Plastic discs can be inserted and act as covers to prevent swarf or chips from clogging these bores. Plastic discs are available in three different diameters Ø 15 mm, Ø 20 mm and Ø 27 mm (see page 56).

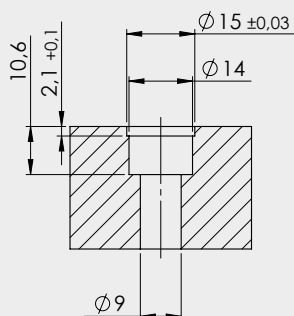

M8

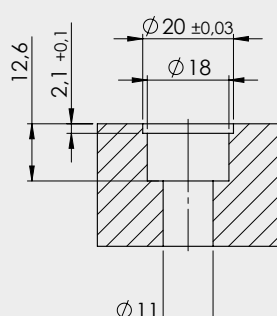

M10

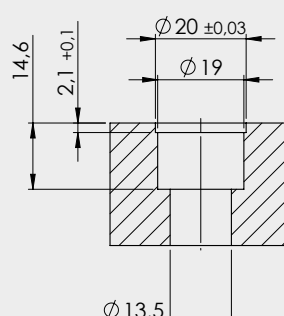

M12

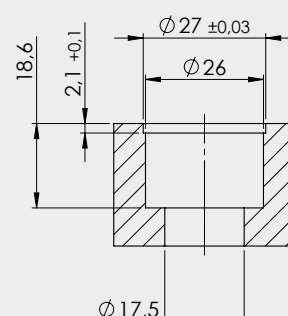

M16

Custom corner radius for Quick-Point® grid / multi-fold plates

Upon request, we can adjust the zero-point system (multi grid or individual grid plates in a row) to round tables of the machine tool

by cutting off the corners. A clean solution that avoids in most cases a protrusion of the zero-point plates to the machine table.



CUSTOM CORNER RADIUS FOR QUICK-POINT® GRID / MULTI-FOLD PLATES

ITEM NO.	QUANTITY
45043-01	Cut off 1 corner
45043-02	Cut off 2 corners
45043-04	Cut off 4 corners